

# SITESOLUTIONS

## Consult



**Report prepared on:**

Industrial Unit at Borron Street, Portwood Industrial Estate, Stockport, SK1 2JD

**Report Reference:**

Argyll\_Conult\_SampleVs6

**National Grid Reference:**

390420,390940

**Report prepared for:**

Specimen Client

**Client Reference:**

Client ref

**Report date:**

5th April 2011

Intelligent Due Diligence  
[www.argyllenvironmental.com](http://www.argyllenvironmental.com)



argyll  
environmental®

## Site Context



### Report prepared on

Industrial Unit at Borron Street, Portwood Industrial Estate, Stockport, SK1 2JD

### Report reference

SiteSolutionsConsult\_Sample\_PotentialLiabilitiesVs6

### National grid reference

390420, 390940

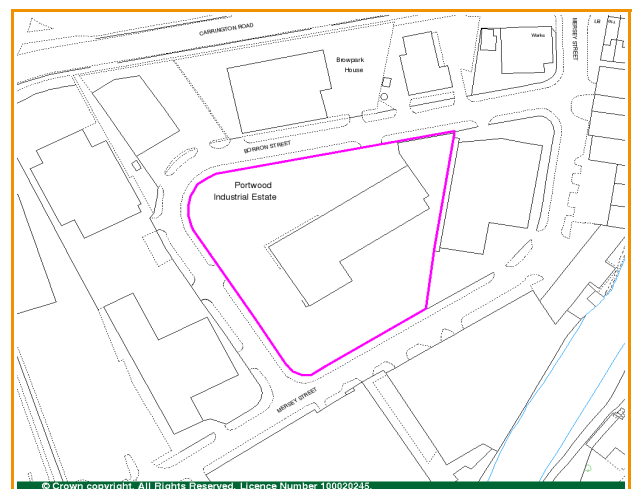

# Summary of Liabilities and Risk

<b>Report prepared on</b>	<b>Site Area (m<sup>2</sup>)</b>	<b>Report Author</b>
Industrial Unit at Borron Street, Portwood Industrial Estate, Stockport, SK1 2JD (the Site)	7251.7	Chris Loaring BA (Hons) MSc, AIEMA Telephone: 0845 458 5250
<b>Current Use</b>	<b>Proposed Use</b>	<b>Additional Information Provided</b>
Light Industrial	Light Industrial	Not Specified

## Liability Assessment

**Within the scope of this assessment no Liabilities have been identified. However, your attention is drawn to the prudent measures suggested below.**

### Recommendations

Given the lack of information regarding recent activities at the Site and its low to medium priority for investigation under Part IIA (as reported the Stockport Metropolitan Borough Council), a prudent purchaser should consider an upgrade to a Site Solutions Inspect (priced at £850 plus VAT and including all disbursements). This study comprises a Site inspection to review the risk presented by recent and current operations. The Site Solutions Inspect can normally be prepared within 5 - 10 working days or to your specific requirements. We will be happy to provide a detailed proposal on request. Please contact us for further information.

## Risk Summary

<b>Overall on-site risk</b>	Moderate
<b>Overall off-site risk</b>	Moderate
<b>Environmental sensitivity rating</b>	High
<b>Plausible pollutant linkage identified<sup>1</sup></b>	Yes

<sup>1</sup>The term 'plausible pollutant linkage' is defined within the Risk Analysis Methodology. Please refer to this section for further information.

## Environmental Hazards

This report is primarily a desktop assessment of potential soil and groundwater liabilities. We also comment whether the following Environmental Hazards are relevant:

### Natural and Mining Related

The following natural or mining related hazards have been identified in the immediate vicinity of the Site:

Risk	Recommendation
Radon between 1 and 3%	Employers are required by the Management of Health and Safety at Work Regulations 1999 to assess risks from radon in workplaces. You may therefore wish to contact the Health Protection Agency for further information regarding radon monitoring.
Mining Instability	As the Site lies in an area subject to mining instability, you may wish to consult a local RICS accredited surveyor and/or review any available geotechnical surveys. Further information may be available from the minerals and waste officer at the County Council and the local Building Controls Officer. British Geological Survey GeoHazard reports ( <a href="http://www.bgs.ac.uk/georeports">www.bgs.ac.uk/georeports</a> ) may also provide more detailed information.
Coal Mining	As the Site lies within a Coal Mining area, it is recommended that a Commercial Coal Mining Report is obtained from the Coal Authority.

Contact details are provided at the end of this report.

### Other Issues

Issue	Recommendation
Telecommunication Base Stations	One or more telecommunication base stations are located within 250m of the Site (please refer to the Current Land Use maps to determine specific locations). Telecommunications equipment emits electromagnetic fields which may have adverse health affects. Further information is available from <a href="http://www.hpa.org.uk">www.hpa.org.uk</a> and <a href="http://www.sitefinder.ofcom.org.uk">www.sitefinder.ofcom.org.uk</a> .
COMAH	One or more Control of Major Accident Hazards (COMAH) sites are located within 500m. Although risks at such facilities are controlled under the COMAH Regulations you should be aware that the Site may lie within an evacuation zone which could be affected if an accident occurred. Additionally, planning restrictions may apply. If redevelopment is planned it would be prudent to contact the local planning department. Further information is available at <a href="http://www.hse.gov.uk/comah/">www.hse.gov.uk/comah/</a> .

### Flood Risk

This report is primarily a soil and groundwater assessment and does not include a flood risk assessment. However flood risk should be considered as it affects 1-in-5 properties in England and Wales. Argyll is able to provide flood risk screening reports suitable for commercial property. These are priced from £85 and any order placed in conjunction with this report will receive a 10% 'bundle' discount off the combined report price.

# Risk Analysis

## On-site sources

The Site was occupied c.1848 by Portwood Hall and assumed to be in residential use with additional residential properties identified on Site by c.1898. By c.1910 the whole Site was occupied by small properties of commercial and residential appearance. The Site was developed into a depot with ancillary buildings c. 1980 under planning consent reference 79/12432. No conditions relating to environmental investigations or remedial works were attached to this consent. By c.1989 the Site is no longer indicated as a depot but is shown as part of Portwood Industrial estate. No significant changes were identified at the Site from later map editions.

The following licences, authorisations and consents were identified at the Site: a Local Authority Pollution Prevention Control for respraying of road vehicles (since revoked), Licensed Waste Management Facility and Registered Waste Transfer site referring to a special waste transfer station first licensed from June 1999 until June 2001 authorised to accept waste including asbestos. Furthermore, an Historic Landfill site was identified at the Site with no further information available concerning dates of operation and types of waste disposed of.

We have been informed by the client that the Site is currently in light industrial use and that it will continue in this use without redevelopment.

Stockport Metropolitan Borough Council has stated that the Site has a low to medium priority for further investigation under Part IIA of the Environmental Protection Act 1990. Manchester Fire Department has reported that there are two redundant below ground storage tanks at the Site both of which were gas freed and decommissioned c. 2000.

As a result of the historical and current use of the Site, there is a **moderate risk** of contaminants being present.

## Off-site sources

A number of historical or current potentially contaminative uses were identified in proximity to the Site. These include: a gravel pit 10m east c.1872, cotton mills 10m south c.1895-1954 and unspecified works and factories, saw mills, foundries and depots from c.1975 until present associated with the wider industrial estate.

According to trade directories, there are a wide range of current or recent operations in proximity to the Site, the most pertinent include garage services, MOT testing centres, glass products manufacturers, car body repairs, engine rebuilding and reconditioning and sheet metal work.

In addition the following licences, consents and contraventions of note were identified:

- a Local Authority Pollution Prevention and Control Enforcement relating to an incident of air pollution 24m south with no further information available.

Furthermore, the following landfill sites were identified in close proximity to the Site: Registered Landfill site approximately 49m north west first licensed August 1987 authorised to accept ceramics, plastics, fibreglass, soil, clay, brick and sand (no boundary provided) and a Historical Landfill site 205m north west accepting waste from December 1987 until December 1990 including inert and industrial materials. The historical and current use of the surrounding area is therefore considered to present a **moderate risk** of affecting the Site.

## **Pathways and receptors**

With reference to the Environment Agency Data, the Superficial hydrogeology underlying the Site is classified as Secondary Aquifer – A (Moderately permeable). These aquifers are formed of permeable layers capable of supporting water supplies at a local scale, and in some cases forming an important source of base flow to rivers. The Bedrock hydrogeology underlying the Site is classified as Principal Aquifer (highly permeable). These aquifers are typically formed of layers of rock or drift deposits that have a permeability and provide a high level of water storage. They may support water supply and/or base river flow on a strategic scale. In terms of the overlying soils, these are given a High (class U) vulnerability classification. According to information provided by the Environment Agency the Site does not lie within a groundwater Source Protection Zone (SPZ). Five abstraction licences are located within 1km. The closest of these are detailed as follows: groundwater abstraction for cooling and manufacturing located 561m south west. The nearest water feature (River Goyt) is located 57m south east. Residential properties are located 60m north east. Although no designated eco-receptors were identified on-site, the following were identified within 1km radius of the Site: Reddish Vale and Woodbank Park Local Nature Reserves located 423m north and 470m south east respectively. Overall, the Site is therefore considered to have a **moderate to high environmental sensitivity**

## **Conclusion**

Considering the information reviewed during this assessment, although plausible source-pathway-receptor relationships have been identified, we believe these are unlikely to result in a Liability, given a continued use without redevelopment.

Please refer to risk analysis methodology section for further guidance and definition of terms.

**For the overall liability assessment for this site please refer to page 3.**

## Current Operations

Whilst this assessment is primarily a desktop assessment of historical soil and groundwater liabilities, the following operational issues that fall outside the scope of the Risk Analysis Methodology have been identified:

### Environmental Damage Regulations 2009 (EDR)

<b>Potential for owner/operation to incur a Liability under the EDR</b>	<b>High</b>
---	-------------

This assessment does not consider actual or potential operations at the Site. It does assess the presence of relevant EDR Receptors<sup>2</sup> within 5km of the Site which could suffer environmental damage in the event of the release of polluting substances. If the potential for environmental damage is high, then a compliance audit could be considered to clarify the standard of environmental management and the risk of regulatory action under EDR. However, this is only likely to be necessary if the Site is in industrial use.

### Regulatory Compliance

The following environmental permits or enforcements have been identified at or within 25m of the Site:

Type	Details	Distance
Local Authority Pollution Prevention Control	Name: Benham (Specialist Cars) Ltd, Location: Mersey Street, STOCKPORT, Cheshire, SK1 2HX, Authority: Stockport Metropolitan Borough Council, Environmental Health Department, EEDD, Permit Ref: Epa043, Status: Authorisation revoked.	0m
Local Authority Pollution Prevention Control Enforcement	Location: Mersey Street, Stockport, Merseyside, Sk1 4aa, Reference: EPA043, Severity: , Dated: Not Supplied/Not Supplied.	24m
Waste Management Facility Location	Licence Number: 53452, Location: Borron Street, Portwood, Stockport, Cheshire, SK1 2JD, Site Category: Special Waste Transfer Stations, Licence Status: Surrendered.	0m
Waste Transfer Site	Licence Holder: North West Water Ltd, Licence Reference: 01144, Site Location: Borrow Street, Portwood, Stockport, Cheshire, Site Category: Transfer, Dated: 11th June 1999.	0m

### Site Specific Considerations

Item	Summary	Suggested Action
Operational Compliance	Such liabilities may arise if the Site is in commercial/industrial use and both the Site and the business are being purchased, or the Site is to be purchased as an investment with an operational business as a tenant.	Compliance audit
Asbestos (Commercial)	If the buildings at the Site were constructed or renovated during the period between 1950 and 1999, then the fabric of these buildings may contain asbestos in a variety of forms.	Check the Asbestos Register and Management Plan
Air Conditioning/Refrigeration Equipment	Air conditioning and refrigeration equipment contains heat transfer fluid. This fluid may be an ozone depleting substance (ODS). Any fluid in a halon fire-extinguishing system is also a ODS.	Inspect maintenance records

<sup>2</sup>Special Protection Areas (Bird Protection Areas), Special Areas of Conservation, Nature Reserves, Landscape Conservation Areas, Natural Parks, National Parks, Biosphere Reserves and Surface Water Features.

Energy Performance Certificate	Under the Energy Performance of Buildings (Certificates and Inspections) (England and Wales) Regulations 2007 and the Energy Performance of Buildings (Scotland) Regulations 2008, there is a requirement for all buildings to have an Energy Performance Certificate (EPC) upon their construction, sale or lease (and in some cases when the building is modified).	Check for EPC or conduct energy assessment
Interceptors	Drainage from car parks or operational areas may discharge to Controlled Waters. This discharge is likely to require treatment prior to release, for example an oil/water interceptor.	Check for valid discharge consent
Sensitive Land Uses	If areas subject to statutory designations are located either on or in proximity to the Site, there may be land management implications or restrictions to planned developments. You are located within 500m of Local Nature Reserves Reddish Vale and Woodbank Park,	Contact local planning authority or speak with planning consultant

## Generic Guidance

Additional sources of information may be available for the Site. These sources could include previous environmental reports (including audits, contaminated land investigation and remediation reports), valuation reports (including property observation checklists), a Land Quality Record, and property deeds. Argyll Environmental would be pleased to review any reports that are available and revise this report accordingly. This may entail additional fees depending upon the volume and complexity of information available. Please contact us for further information.



## Consultation and Review

The following regulatory bodies have been contacted as part of this assessment in respect of Industrial Unit at Borron Street, Portwood Industrial Estate, Stockport, SK1 2JD found at National Grid Reference (NGR: 390420, 390940).

### Local Authority

Stockport Metropolitan Borough Council, Hygarth House, 103 Wellington Road South, Stockport, Greater Manchester, SK1 3TP, Telephone: 0161 480 4949, Fax: 0161 477 9530.

Environmental Health Department	The Local Authority has reported that it has no specific concerns regarding soil or groundwater conditions at the Site. However, it has noted that the Site is regarded as a low to medium priority for further investigation under Part 2A of the Environmental Protection Act 1990. The Local Authority has confirmed that the Site does not hold a Local Area Air Pollution Control and has never been subject to any enforcement action, as indicated by the existing data.
Planning Department	Planning records indicate that permission was granted to develop the Site for light industrial use in 1979 (application ref: 79/12432). No conditions relating to the requirement for environmental investigations or remedial works were attached to this consent. No other significant planning applications were noted.
Building Control	The Building Control Department has confirmed that no remedial measures were required during development of the Site c. 1980. In addition, it holds no information regarding any adverse soil groundwater conditions at or in the vicinity of the Site.

### Petroleum Licencing

Stockport Metropolitan Borough Council, Hygarth House, 103 Wellington Road South, Stockport, Greater Manchester, SK1 3TP, Telephone: 0161 480 4949, Fax: 0161 477 9530.

Manchester Fire Department	Manchester Fire Department has reported that there are two redundant below ground storage tanks at the Site. Both held approximately 2,500 litres of petrol and were gas freed and infilled with concrete slurry in 2000. This department has no knowledge of any previous spills or leaks and was satisfied with the standard of decommissioning.
----------------------------	--

### Report Review

The following reports have been reviewed as part of this assessment:

Phase I	A phase one compliance audit was completed at the Site in October 1999 by consultants UnSure Limited (reference US456783). No Material soil and groundwater issues were noted, however a number of minor compliance issues were found mainly relating to material storage, including an unbunded above ground oil storage tank.
Phase II	None available.
Other	None available

## Risk Analysis Methodology

The Site Solutions Consult report has been designed to assist in making informed decisions during property transactions. The Report is a desktop assessment of direct liabilities (Liabilities) which could affect the owner /occupier of the Site and arise under Part 2A of the Environmental Protection Act 1990 and/or equivalent requirements under planning regime and/or the Water Resources Act 1991 <sup>3</sup>(Relevant Legislation). If a risk is identified, then a number of options for finding out more about the risk, managing it or transferring it are proposed.

The assessment of environmental liability under the Relevant Legislation is based upon the principle of determining the presence of a plausible source-pathway-receptor relationship. A 'source' is a source of contamination, a 'pathway' is a medium through which the contamination can mobilise and 'a receptor' is a person or entity that could be detrimentally affected by the contamination. If all three are identified, then a 'plausible source-pathway-receptor relationship' may be present. By definition, this is one which Argyll believes could result in significant harm, a significant risk of significant harm or pollution of Controlled Waters.

In our assessment we use the following test to decide if there is a potential liability affecting the Site. For the purpose of this assessment a site where a potential Liability has been identified is defined as follows:

*A Site which, from the information assessed by Argyll, is considered to have the potential of being affected by contaminative substances present in or under the Site (but excluding potential sources of contamination on or above the land) such that, on the basis of its current or proposed use, there is a reasonable likelihood of a UK regulatory authority, acting in accordance with Relevant Legislation, requiring that remedial measures are taken in order to remedy or mitigate the contaminative substances that are present in or under the land that forms all or part of the Site.*

The term Liabilities is defined within the scope of this assessment to mean, remedial works under Part 2A of the Environmental Protection Act 1990 (or where appropriate, equivalent requirements under the planning regime) and/or the Water Resources Act 1991 which may result in direct liability for the site owner/occupier.

The assessment within the Report has been produced and quality checked by a team of qualified environmental professionals. The assessment is based upon a manual review of the data contained within the Data Section of this Report and of 1:2500 and 1:1250 (where available) scale historical mapping and information provided by regulatory authorities.

## Ecological Risk Assessment

The evaluation of ecological risk is becoming an increasingly important input when making risk management decisions. In the Site Solutions Consult report, Argyll assesses two different drivers for risks and liabilities driven by ecological receptors;

1. The Contaminated Land Regime; and
2. The Environmental Damage Regulations 2009.

The Environment Agency has designed a generic framework for conducting ecological risk assessment (see Assessing Risk to Ecosystems from Land Contamination, R&D Technical Report P299, EA 2002). This recommends a tiered approach in line with best practice for human health and controlled water risk assessment and defines

<sup>3</sup>Water Environment (Controlled Activities)(Scotland) Regulations 2005 where appropriate.

Relevant Ecological Receptors as any type of receptor set out in Chapters 2 and 3 in Table A, Annex 3, of Defra Circular 012/2006, Environmental Protection Act 1990: Part 2A Contaminated Land.

Argyll assesses Relevant Ecological receptors as part of its assessment process. To do so it uses the Argyll EcoRisk model which was developed and tested in consultation with leading experts and is based on the Environment Agency framework.

The Environmental Damage (Prevention and Remediation) Regulations 2009 were introduced on 1 March 2009 to implement the provisions of the European Commission's Environmental Liability Directive into law in England<sup>4</sup>. The Environmental Damage Regulations aim to prevent and remedy damage to protected species or natural habitats or a site of special scientific interest, surface water, groundwater or to land. 'Environmental damage' has a specific meaning in the Regulations, and covers only the most severe cases. Existing legislation with provisions for environmental liability remains in place. The Regulations apply on land in England and on the seabed around the UK up to the limits set out in the Continental Shelf Act 1964, and to waters in the Renewable Energy Zone, which extends approximately 200 miles out to sea.

Argyll does not consider the standard of current operations, but reports the potential for environmental damage based on the location of EDR Receptors around the Site.

When conducting either assessment, Argyll will primarily assess information provided in the Data section of the Report. However, in some cases Argyll may choose to supplement this with freely available public information such as that provided by English Nature and/or information provided by the Argyll Europa System.

## **Alternatives for Liability Assessment**

In this section Argyll will report on any potential soil and groundwater liabilities which it considers are associated with the Site. Our assessment of Liability is based upon the proposed and current use of the Site (as supplied by the client) in line with current Government guidance.

There will be one of three responses:

**1 - Within the scope of this assessment no Liabilities have been identified. No further action is required.**

This statement indicates that within the scope of this assessment, no issues have been identified that are likely to result in significant cost liabilities under Relevant Legislation.

**2 - Within the scope of this assessment no Liabilities have been identified. However, your attention is drawn to the prudent enquiries suggested below.**

This statement indicates that within the scope of this assessment, no issues have been identified that are likely to result in significant cost liabilities under Relevant Legislation. However, a client may wish to obtain further information about other issues disclosed in the Report, which could be material.

**3 - Potential Liabilities have been identified under Part 2A of the Environmental Protection Act 1990 (or where appropriate, equivalent requirements under the planning regime) and/or the Water Resources Act 1991<sup>5</sup>. To quantify these you may decide to undertake a more detailed assessment through the recommendation(s) set out below.**

---

<sup>4</sup> Environmental Damage (Prevention and Remediation) (Wales) Regulations 2009 or Environmental Damage (Prevention and Remediation) (Scotland) Regulations where appropriate.

<sup>5</sup>Water Environment (Controlled Activities)(Scotland) Regulations 2005 where appropriate.

This statement indicates that within the scope of this assessment, an issue or a number of issues have been identified that are likely to result in significant cost liabilities under Relevant Legislation. In this event, recommendations are made, in order that additional information is collected so that the liabilities may be more accurately assessed.

## **Limitations of the Report**

The Site Solutions Consult report has been designed to satisfy standard environmental due-diligence enquiries, as recommended by the Law Society. It is a 'remote' investigation and reviews only information provided by the client, regulatory bodies and from the databases of publicly available information that have been chosen to enable a desk based environmental assessment of the Site. The Report does not include a site investigation. Therefore, Argyll cannot guarantee that all land uses or factors of concern will have been identified by the Report.

The information in the Data Section of the Report is derived from a number of statutory and non-statutory sources. While every effort is made to ensure accuracy, Argyll cannot guarantee the accuracy or completeness of such information or data. Argyll will not accept responsibility for inaccurate data provided by external data providers.

Further information regarding our risk assessment methodology is provided in the Products and Services User Manual which is available free of charge from the client area of our website [www.argyllenvironmental.com](http://www.argyllenvironmental.com). For further information regarding the datasets reviewed within our assessment, please contact one of our technical team on 0845 458 5250. This report is provided under The Argyll Environmental Terms and Conditions for Data Reports, a copy of which is available on our website.

# Contents of the Data Section

<b>Tabular Summary</b>	<p>This section presents a tabular summary of information found for the Site and surrounding area. The data is presented in three buffer zones for ease of reference: data found at the Site, from 1-250m and from 251-500m.</p> <p>If a database has been searched the number of records found will be displayed under the relevant search band. If a database is not available or has not been searched, this will be represented by the abbreviation N/A under the relevant search band.</p>
<b>Current Land Use</b>	<p>This section provides information on current land uses and is divided into three sections, statutory information, waste and current industrial uses. It is preceded by two maps.</p> <p>The accurate large-scale Site Layout Plan confirms the Site boundary with statutory, waste and current land use information presented within 250m.</p> <p>The smaller scale map Site Location Map presents the Site's setting and statutory, waste and current land use information within 500m of the Site boundary.</p>
<b>Statutory Information</b>	<p>This section presents detailed statutory information for the Site and surrounding area (up to 500m depending upon dataset). The Map ID of each feature is indicated (where applicable) followed by specific information on each feature and its distance and direction from the Site.</p>
<b>Waste</b>	<p>This section presents detailed information on waste and landfill sites for the Site and surrounding area (up to 500m depending upon dataset). The Map ID of each feature is indicated (where applicable) followed by specific information on each feature and its distance and direction from the Site.</p>
<b>Current Industrial Land Use</b>	<p>This section presents detailed information on current land use for the Site and surrounding area (0-250m). The Map ID of each feature is indicated (where applicable) followed by specific information on each feature and its distance and direction from the Site.</p>
<b>Historical Land Use</b>	<p>This section presents selected information on historical land use for the Site and surrounding area (0-500m). These features are not mapped. A table listing the historical maps used in the risk assessment is also provided.</p>
<b>Aquifer Designations and Geology</b>	<p>This section is preceded by two maps that present information relating to the aquifer designations beneath the Site. The first of these maps indicates the designation of the Superficial geology. The second map presents the aquifer designation of the solid geology.</p> <p>These maps are followed by detailed information in relation to aquifer designations/groundwater vulnerability and geology at the Site and surrounding area (0-500m).</p>
<b>Environmental Sensitivity</b>	<p>This section presents detailed information on the environmental sensitivity of the Site and surrounding area (up to 500m depending upon dataset) and is preceded by two maps. The first shows areas with statutory designations, the second shows source protection zones. The Map ID of each feature is indicated (where applicable) followed by specific information on each feature and its distance and direction from the Site.</p>
<b>Natural and Mining Related Hazards</b>	<p>This section contains information on natural and mining related hazards which may affect the Site. These include subsidence, radon and mining.</p>

© Landmark Information Group Limited 2011. All Rights Reserved. The copyright on the information and data as contained in the Data section of this Report ("Report") is the property of Landmark Information Group Limited ("Landmark") and several other Data Providers, including (but not limited to) Ordnance Survey, British Geological Survey, the Environment Agency and English Nature, and must not be reproduced in whole or in part by photocopying or any other method.

## Tabular Summary

<b>Statutory Information</b>	<b>On-site</b>	<b>1-250m</b>	<b>251-500m</b>
Local Authority Pollution Prevention and Controls	1	1	2
Local Authority Integrated Pollution Prevention and Controls	0	0	0
Integrated Pollution Controls	0	0	0
Integrated Pollution Prevention And Control	0	0	0
Registered Radioactive Substances	0	0	0
Discharge Consents	0	11	9
Water Industry Act Referrals	0	0	0
Control of Major Accident Hazards Sites	0	0	2
Explosive Sites	0	0	0
Notification of Installations Handling Hazardous Substances	0	0	1
Planning Hazardous Substance Consents	0	0	2
Contaminated Land Register Entries and Notices	0	0	0
Local Authority Pollution Prevention and Control Enforcements	0	1	0
Enforcement and Prohibition Notices	0	0	0
Planning Hazardous Substance Enforcements	0	0	0
Substantiated Pollution Incident Register	0	0	0
Prosecutions Relating to Authorised Processes	0	0	0
Prosecutions Relating to Controlled Waters	0	0	0

<b>Waste</b>	<b>On-site</b>	<b>1-250m</b>	<b>251-500m *(501 - 750m)</b>
BGS Recorded Landfill Sites	0	0	0 (2) *
Integrated Pollution Control Registered Waste Sites	0	0	0
Licensed Waste Management Facilities (Landfill Boundaries)	0	0	0
Licensed Waste Management Facilities (Locations)	1	0	1 (2) *
Local Authority Recorded Landfill Sites	0	0	0 (0) *
Registered Landfill Sites	0	1	0 (0) *
Registered Waste Transfer Sites	1	0	2
Registered Waste Treatment or Disposal Sites	0	0	0
Historical Landfill Sites	1	1	3

<b>Current Land Use</b>	<b>On-site</b>	<b>1-250m</b>	<b>251-500m</b>
Contemporary Trade Directory Entries	0	52	60
Fuel Station Entries	0	0	1
Telecommunication Base Stations	0	1	5

<b>Historical Land Use</b>	<b>On-site</b>	<b>1-250m</b>	<b>251-500m</b>
Historical Tanks And Energy Facilities	0	8	23
Former Marshes	0	0	0
Potentially Infilled Land (Non-Water)	0	3	1

<b>Historical Land Use</b>	<b>On-site</b>	<b>1-250m</b>	<b>251-500m</b>
Potentially Infilled Land (Water)	0	0	6
<b>Groundwater Vulnerability</b>			
Superficial Aquifer Designations	1	1	4
Bedrock Aquifer Designations	1	0	1
Groundwater Vulnerability	1	0	1
Low Permeability Drift Deposits	0	N/A	N/A
BGS 1:50,000 Bedrock Geology	1	1	1
BGS 1:50,000 Superficial Deposits	1	3	4
BGS 1:50,000 Geological Mapping Coverage	1	0	0
Detailed River Network Lines	0	1	11
Detailed River Network Offline Drainage	0	0	0
BGS 1:625,000 Solid Geology	1	N/A	N/A
BGS Borehole Logs	0	1	N/A
<b>Environmental Sensitivity</b>			
	<b>On-site</b>	<b>1-250m</b>	<b>251-500m *(501 - 1km)</b>
Areas of Outstanding Natural Beauty	0	0	0
Environmentally Sensitive Areas	0	0	0
Forest Parks	0	0	0
Local Nature Reserves	0	0	2 (0) *
Marine Nature Reserves	0	0	0 (0) *
National Nature Reserves	0	0	0 (0) *
National Parks	0	0	0
National Scenic Areas	0	0	0
Nitrate Sensitive Areas	0	N/A	N/A
Nitrate Vulnerable Zones	0	N/A	N/A
Ramsar Sites	0	0	0 (0) *
River Quality	0	1	1
River Quality Biology Sampling Points	0	0	0
River Quality Chemistry Sampling Points	0	0	0
Nearest Surface Water Feature	0	1	0
Sites of Special Scientific Interest	0	0	0 (0) *
Special Areas of Conservation	0	0	0 (0) *
Special Protection Areas	0	0	0 (0) *
Water Abstractions	0	0	0 (5) *
Source Protection Zones	0	2	0
<b>Natural and Mining Related Hazards</b>			
	<b>On-site</b>	<b>1-250m</b>	<b>251-500m</b>
Collapsible Ground Stability Hazards	0	0	N/A
Compressible Ground Stability Hazards	1	0	N/A
Ground Dissolution Stability Hazards	0	0	N/A
Landslide Ground Stability Hazards	1	0	N/A
Running Sand Ground Stability Hazards	1	0	N/A

<b>Natural and Mining Related Hazards</b>	<b>On-site</b>	<b>1-250m</b>	<b>251-500m</b>
Shrinking or Swelling Clay Subsidence Hazards	1	1	N/A
Non-Coal Mining Hazards	0	0	N/A
Radon Potential	1	N/A	N/A
Radon Protection Measures	1	N/A	N/A
Brine Compensation Areas	0	N/A	N/A
Coal Mining Affected Areas	1	N/A	N/A
Natural and Mining Cavities	0	0	0
Mining Instability	1	0	N/A
BGS Recorded Mineral Sites	0	0	3

#### **Tabular Summary Explanation**

Argyll has carefully selected a range of datasets which are considered appropriate for the intended use of this report. Each dataset is searched to a set radius from the Site boundary and the tabular summary is divided into different search bands accordingly. If a database is searched and information is found, then the number of records available are detailed in the table above. If the database was searched and no data was found, then a zero will be present. If a database was not searched then the abbreviation N/A will be found, indicating this information was not available at the radius searched.

#### **Landfill Site Information**

Registered landfill site boundaries (where available), are shown on the map as a red diagonal hatched polygon and referred to in the map legend as Registered Landfill Sites. At present no complete national dataset exists for landfill site boundaries, therefore a point grid reference provided by the data supplier is used for some landfill sites. The point grid references supplied provide only an approximate position, and can vary from the site entrance to the centre of the site. A point cannot properly define landfill boundaries therefore Landmark constructs a 250 metre or 100 metre "buffer" zone around the point to warn of the possible presence of landfill. The "buffer" zone is shown on the map as an orange crosshatched area and is referred to in the map legend as Potential Landfill Buffer.

Local Authority landfill data is sourced from individual local authorities that were able to provide information on sites operating prior to the introduction of the Control of Pollution Act (COPA) in 1974. Appropriate authorities are listed under Local Authority Landfill Coverage with an indication of whether or not they were able to make landfill data available. Details of any records identified are disclosed. You should be aware that if the local authority had landfill data but passed it to the relevant Environment Agency office, it does not necessarily mean that local authority landfill data is now included in our other Landfill datasets. In addition if no data has been made available for all or part of the search area, you should be aware that a negative response under 'Local Authority Recorded Landfill Sites' does not necessarily confirm that no local authority landfills exist.

#### **Subsidence Hazards**

Information on subsidence hazards is provided by the British Geological Survey (BGS). Information present within 250m of the Site is reported under Natural and Mining Related Hazards. Due to the level of detail of this data and the complexities of the real world, the BGS recommends a precautionary approach when using this information and advises taking the worst reading noted for each dataset within the vicinity of a property. Therefore, Argyll reports the presence of a ground stability or non-coal related mining hazard in the Risk Analysis section based on the highest reading found within 50m of the Site boundary.



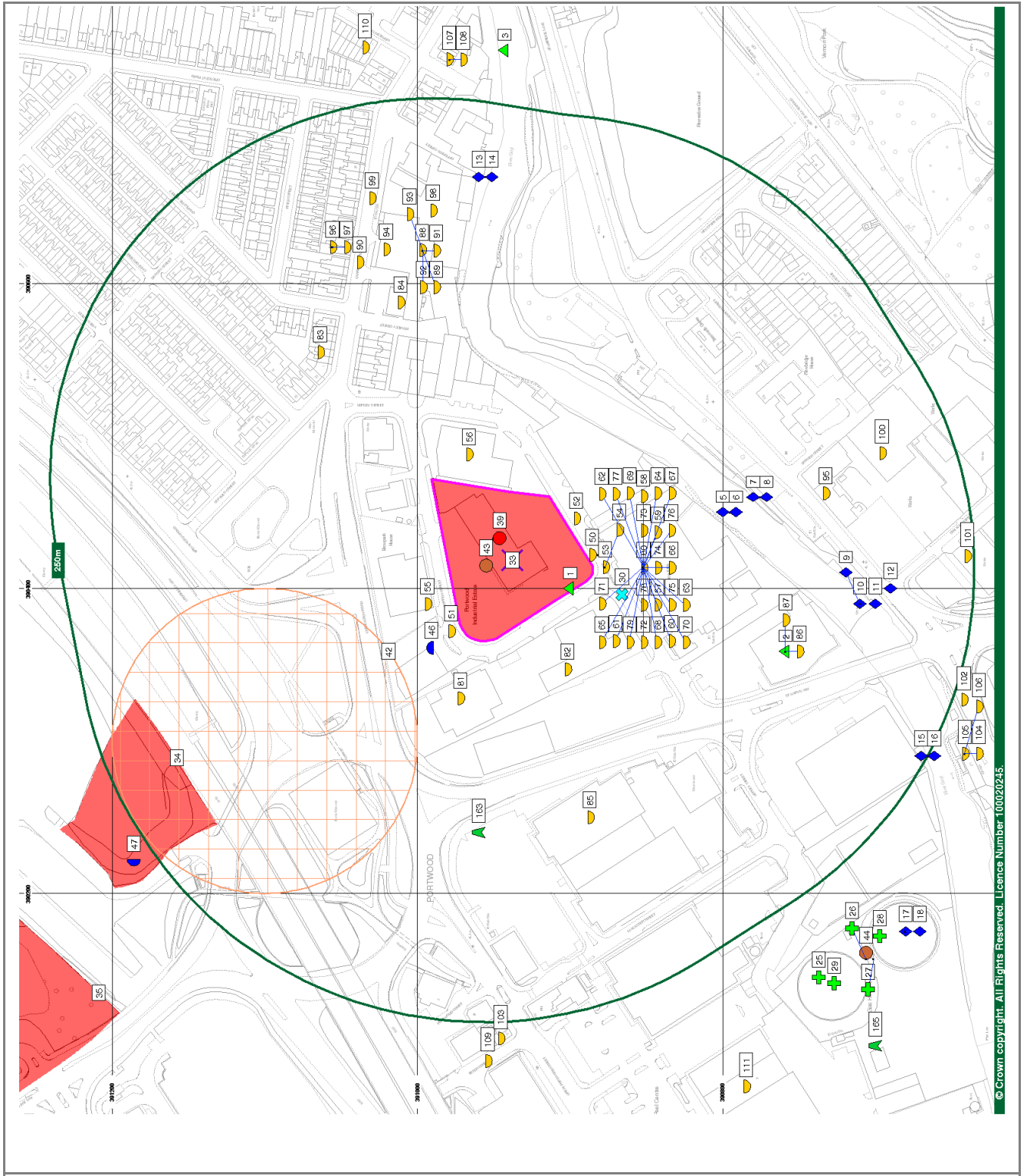

Current Land Use within 250m	
<b>General</b>	<ul style="list-style-type: none"> <li>Site Boundary</li> <li>Bearing Reference Point</li> <li>Reference Number</li> <li>Search Buffer</li> <li>Grid Lines</li> <li>North Arrow</li> </ul>
<b>Waste/Landfill Sites</b>	<ul style="list-style-type: none"> <li>BSS Recorded Landfill Site</li> <li>EA Historic Landfill (Polygon)</li> <li>EA Historic Landfill (Buffered Point)</li> <li>Licensed Waste Management Facilities (Landfill)</li> <li>Local Authority Recorded Landfill Site</li> <li>Registered Landfill Site</li> <li>Registered Waste Transfer Site</li> <li>Registered Waste Treatment or Disposal Site</li> <li>Registered Landfill Site</li> <li>Potential Landfill Buffer</li> <li>Point Location of Registered Landfill Site</li> <li>Point Location of BSS Recorded Landfill Site</li> <li>Licensed Waste Facilities (Location)</li> <li>Local Authority Recorded Landfill Site</li> <li>Point Location of Registered Waste Transfer Site</li> <li>Registered Waste Treatment or Disposal Site</li> <li>Potential Landfill Buffer</li> </ul>
<b>Statutory Authorisations</b>	<ul style="list-style-type: none"> <li>Local Authority Pollution Prevention and Control</li> <li>Point Location of Contaminated Land Register Entry or Notice</li> <li>Discharge Consents</li> <li>Industrial Processes</li> <li>Storage of Hazardous Substances</li> <li>Contraventions</li> <li>Potentially Contaminative Use</li> <li>Miscellaneous</li> </ul>
<b>Statutory Authorisations</b>	<ul style="list-style-type: none"> <li>Contaminated Land Register Entry or Notice</li> <li>Registered Radioactive Substance</li> <li>Water Industry Act Referral</li> <li>Integrated Pollution Control Registered Waste Site</li> <li>Local Authority Integrated Pollution Prevention and Control</li> <li>Explosive Site</li> <li>NHHS</li> <li>Enforcement and Prohibition Notice</li> <li>Substantiated Pollution Incident Register</li> <li>Prosecution Relating to Authorised Processes to Controlled Waters</li> <li>Potentially Contaminative Use</li> <li>Fuel Station Entry</li> <li>BSS Recorded Mineral Site</li> <li>BSS Borehole</li> <li>Telecommunication Base Station</li> </ul>
<b>Discharge Consents</b>	<ul style="list-style-type: none"> <li>Water Industry Act Referral</li> </ul>
<b>Industrial Processes</b>	<ul style="list-style-type: none"> <li>Integrated Pollution Control Registered Waste Site</li> <li>Local Authority Integrated Pollution Prevention and Control</li> </ul>
<b>Storage of Hazardous Substances</b>	<ul style="list-style-type: none"> <li>Explosive Site</li> <li>NHHS</li> </ul>
<b>Contraventions</b>	<ul style="list-style-type: none"> <li>Local Authority Pollution Prevention and Control Enforcement</li> <li>Planning Hazardous Substance Enforcement</li> <li>Prosecution Relating to Authorised Processes to Controlled Waters</li> </ul>
<b>Potentially Contaminative Use</b>	<ul style="list-style-type: none"> <li>Potentially Contaminative Use</li> <li>Fuel Station Entry</li> </ul>
<b>Miscellaneous</b>	<ul style="list-style-type: none"> <li>BSS Recorded Mineral Site</li> <li>BSS Borehole</li> <li>Telecommunication Base Station</li> </ul>

© Crown copyright. All Rights Reserved. Licence Number 100020245.

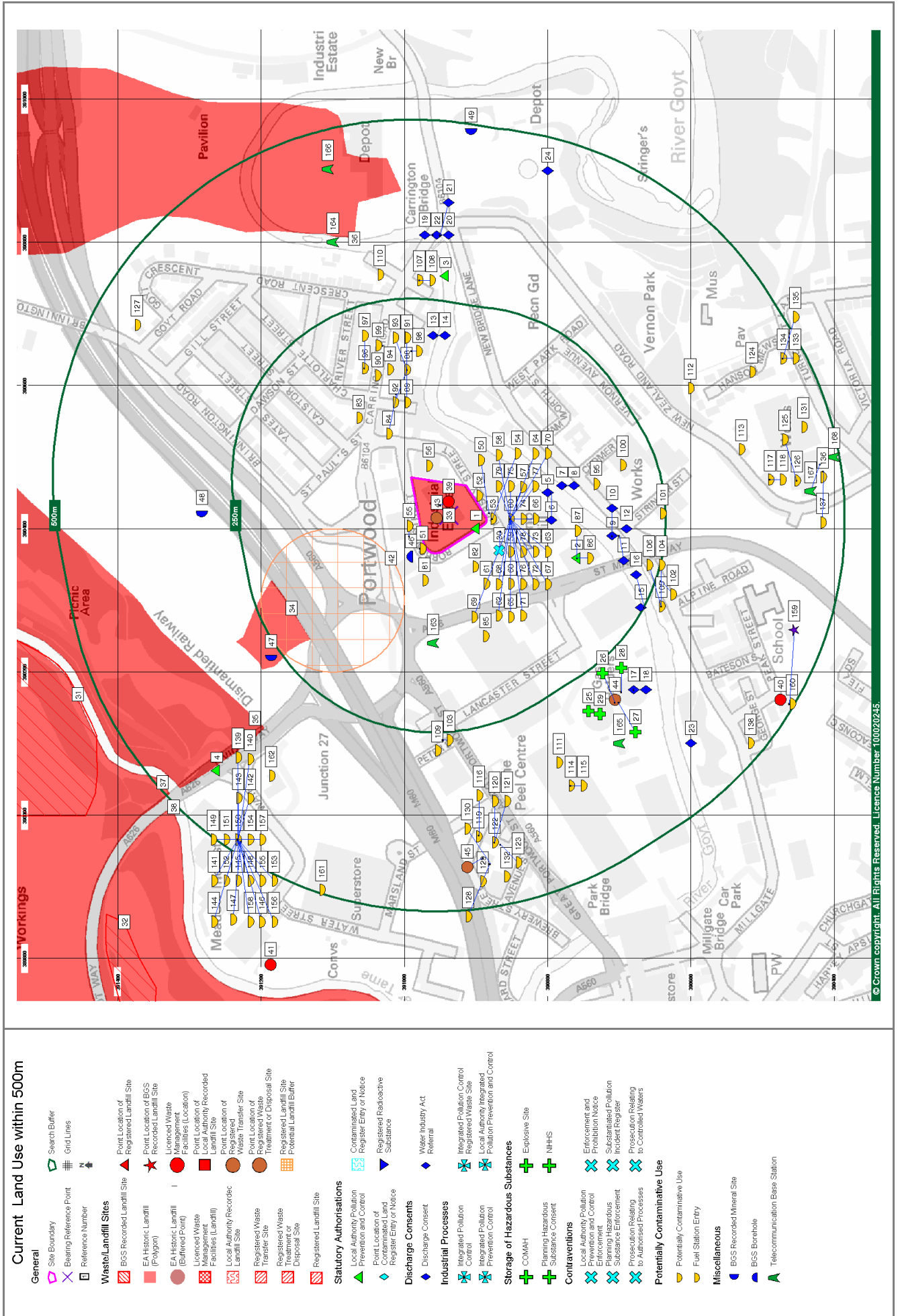

# Statutory Information

Map ID	Details	Distance	Direction
--------	---------	----------	-----------

## Authorisations

### Local Authority Pollution Prevention and Controls

1	Name: Benham (Specialist Cars) Ltd, Location: Mersey Street, STOCKPORT, Cheshire, SK1 2HX, Authority: Stockport Metropolitan Borough Council, Environmental Health Department, EEDD, Permit Ref: Epa043, Dated: Not Supplied, Process Type: Local Authority Air Pollution Control, Description: PG6/34 Respraying of road vehicles, Status: Authorisation revoked, Positional Accuracy: Located by supplier to within 100m.	0m	SW
2	Name: Horns Of Stockport, Location: St Mary's Way, STOCKPORT, Cheshire, SK1 2HY, Authority: Stockport Metropolitan Borough Council, Environmental Health Department, EEDD, Permit Ref: Epa059, Dated: Not Supplied, Process Type: Local Authority Air Pollution Control, Description: PG6/34 Respraying of road vehicles, Status: Authorisation revoked, Positional Accuracy: Automatically positioned to the address.	137m	S
3	Name: Thomas Storey, Location: Tiviot Works, Epplestone Street, STOCKPORT, Cheshire, SK1 2AL, Authority: Stockport Metropolitan Borough Council, Environmental Health Department, EEDD, Permit Ref: Epa030, Dated: Not Supplied, Process Type: Local Authority Air Pollution Control, Description: PG6/10 Coating manufacturing, Status: Application exempt from APC, Positional Accuracy: Un-geocodable - location cannot be found.	286m	E
4	Name: Tesco Filling Station, Location: Tiviot Way, STOCKPORT, SK1 2BT, Authority: Stockport Metropolitan Borough Council, Environmental Health Department, EEDD, Permit Ref: PPC098, Dated: 25th February 2005, Process Type: Local Authority Pollution Prevention and Control, Description: PG1/14 Petrol filling station, Status: Permitted, Positional Accuracy: Manually positioned to the address or location.	426m	NW

## Discharges

### Discharge Consents

5	Operator: United Utilities Water Plc, Property Type: Sewage Disposal Works - Water Company, Location: Borrton St/Longton St, Portwood, Greater Manchester, Authority: Environment Agency, North West Region, Catchment Area: Not Given, Permit Ref: 01STK0083, Permit Version: 1, Effective Date: 1st January 1995, Issued Date: Not Supplied, Revocation Date: 1st January 1995, Discharge Type: Public Sewage: Storm Sewage Overflow, Discharge Environment: Freshwater Stream/River, Receiving Water: River Goyt, Status: Consent revoked or revised: New Consent issued (Section 37(1)), Positional Accuracy: Located by supplier to within 100m.	93m	S
6	Operator: United Utilities Water Plc, Property Type: Sewage Disposal Works - Water Company, Location: Borrton St/Longton St, Portwood, Greater Manchester, Authority: Environment Agency, North West Region, Catchment Area: Not Given, Permit Ref: 016982655, Permit Version: 1, Effective Date: 30th September 1994, Issued Date: Not Supplied, Revocation Date: Not Supplied, Discharge Type: Public Sewage: Storm Sewage Overflow, Discharge Environment: Freshwater Stream/River, Receiving Water: River Mersey Goyt, Status: Post National Rivers Authority Legislation where issue date > 31/08/1989, Positional Accuracy: Located by supplier to within 100m.	98m	S
7	Operator: United Utilities Water Plc, Property Type: Sewage Disposal Works - Water Company, Location: Newbridge Lane Cromer St, Cromer Street, Portwood, Greater Manchester, Authority: Environment Agency, North West Region, Catchment Area: Not Given, Permit Ref: 01STK0088, Permit Version: 1, Effective Date: 1st January 1995, Issued Date: Not Supplied, Revocation Date: 1st January 1995, Discharge Type: Public Sewage: Storm Sewage Overflow, Discharge Environment: Freshwater Stream/River, Receiving Water: River Goyt, Status: Consent revoked or revised: New Consent issued (Section 37(1)), Positional Accuracy: Located by supplier to within 100m.	115m	S

Map ID	Details	Distance	Direction
8	Operator: United Utilities Water Plc, Property Type: Sewage Disposal Works - Water Company, Location: Newbridge Lane Cromer St, Cromer Street, Portwood, Greater Manchester, Authority: Environment Agency, North West Region, Catchment Area: Not Given, Permit Ref: 016982658, Permit Version: 1, Effective Date: 30th September 1994, Issued Date: Not Supplied, Revocation Date: Not Supplied, Discharge Type: Public Sewage: Storm Sewage Overflow, Discharge Environment: Freshwater Stream/River, Receiving Water: River Goyt, Status: Post National Rivers Authority Legislation where issue date > 31/08/1989, Positional Accuracy: Located by supplier to within 100m.	120m	S
10	Operator: United Utilities Water Plc, Property Type: Sewage Disposal Works - Water Company, Location: Newbridge Lane Portwood, Portwood, Greater Manchester, Authority: Environment Agency, North West Region, Catchment Area: Not Given, Permit Ref: 01STK0089, Permit Version: 1, Effective Date: 1st January 1995, Issued Date: Not Supplied, Revocation Date: 29th September 2003, Discharge Type: Public Sewage: Storm Sewage Overflow, Discharge Environment: Freshwater Stream/River, Receiving Water: River Goyt, Status: Consent revoked or revised: New Consent issued (Section 37(1)), Positional Accuracy: Located by supplier to within 10m.	177m	S
9	Operator: United Utilities Water Plc, Property Type: Sewage Disposal Works - Water Company, Location: Newbridge Lane Portwood, Portwood, Greater Manchester, Authority: Environment Agency, North West Region, Catchment Area: Not Given, Permit Ref: 016982659, Permit Version: 1, Effective Date: 30th September 1994, Issued Date: Not Supplied, Revocation Date: 30th September 1994, Discharge Type: Public Sewage: Storm Sewage Overflow, Discharge Environment: Freshwater Stream/River, Receiving Water: River Goyt, Status: Consent revoked or revised: New Consent issued (Section 37(1)), Positional Accuracy: Located by supplier to within 10m.	177m	S
11	Operator: United Utilities Water Plc, Property Type: Sewerage Network - Sewers - Water Company, Location: Stringer St/Newbridge Lane Cso, Stockport, Cheshire, Sk1 2nz, Authority: Environment Agency, North West Region, Catchment Area: Goyt, Permit Ref: 016892181, Permit Version: 1, Effective Date: 25th September 2003, Issued Date: 25th September 2003, Revocation Date: Not Supplied, Discharge Type: Public Sewage: Storm Sewage Overflow, Discharge Environment: Freshwater Stream/River, Receiving Water: River Goyt, Status: New Consent (Water Resources Act 1991, Section 88 & Schedule 10 as amended by Environment Act 1995), Positional Accuracy: Located by supplier to within 10m.	187m	S
12	Operator: United Utilities Water Plc, Property Type: Sewerage Network - Sewers - Water Company, Location: Stringer St/Newbridge Lane Cso, Stockport, Cheshire, Sk1 2nz, Authority: Environment Agency, North West Region, Catchment Area: Not Supplied, Permit Ref: 01stk0089, Permit Version: 2, Effective Date: 30th September 2003, Issued Date: 30th September 2003, Revocation Date: Not Supplied, Discharge Type: Public Sewage: Storm Sewage Overflow, Discharge Environment: Freshwater Stream/River, Receiving Water: River Goyt, Status: Modified (Water Resources Act 1991, Schedule 10 as amended by Environment Act 1995), Positional Accuracy: Located by supplier to within 10m.	196m	S
13	Operator: United Utilities Water Plc, Property Type: Sewage Disposal Works - Water Company, Location: Carrington Rd/Offerton St, Portwood, Greater Manchester, Authority: Environment Agency, North West Region, Catchment Area: Not Given, Permit Ref: 01STK0132, Permit Version: 1, Effective Date: 1st January 1995, Issued Date: Not Supplied, Revocation Date: 1st January 1995, Discharge Type: Public Sewage: Storm Sewage Overflow, Discharge Environment: Freshwater Stream/River, Receiving Water: River Goyt, Status: Consent revoked or revised: New Consent issued (Section 37(1)), Positional Accuracy: Located by supplier to within 100m.	201m	E

Map ID	Details	Distance	Direction
14	Operator: United Utilities Water Plc, Property Type: Sewage Disposal Works - Water Company, Location: Carrington Rd/Offerton St, Portwood, Greater Manchester, Authority: Environment Agency, North West Region, Catchment Area: Not Given, Permit Ref: 016982686, Permit Version: 1, Effective Date: 30th September 1994, Issued Date: Not Supplied, Revocation Date: Not Supplied, Discharge Type: Public Sewage: Storm Sewage Overflow, Discharge Environment: Freshwater Stream/River, Receiving Water: River Goyt, Status: Post National Rivers Authority Legislation where issue date > 31/08/1989, Positional Accuracy: Located by supplier to within 100m.	202m	E
15	Operator: United Utilities Water Plc, Property Type: Sewage Disposal Works - Water Company, Location: Lancaster St, Portwood, Greater Manchester, Authority: Environment Agency, North West Region, Catchment Area: Not Given, Permit Ref: 01STK0101, Permit Version: 1, Effective Date: 1st January 1995, Issued Date: Not Supplied, Revocation Date: 1st January 1995, Discharge Type: Public Sewage: Storm Sewage Overflow, Discharge Environment: Freshwater Stream/River, Receiving Water: River Goyt, Status: Consent revoked or revised: New Consent issued (Section 37(1)), Positional Accuracy: Located by supplier to within 100m.	247m	SW
16	Operator: United Utilities Water Plc, Property Type: Sewage Disposal Works - Water Company, Location: Lancaster St, Portwood, Greater Manchester, Authority: Environment Agency, North West Region, Catchment Area: Not Given, Permit Ref: 016982666, Permit Version: 1, Effective Date: 30th September 1994, Issued Date: Not Supplied, Revocation Date: Not Supplied, Discharge Type: Public Sewage: Storm Sewage Overflow, Discharge Environment: Freshwater Stream/River, Receiving Water: River Goyt, Status: Post National Rivers Authority Legislation where issue date > 31/08/1989, Positional Accuracy: Located by supplier to within 100m.	251m	SW
17	Operator: Transco North West, Property Type: Sewage Disposal Works - Other, Location: Stockport Gas Holder Station, Stockport, Greater Manchester, Authority: Environment Agency, North West Region, Catchment Area: Not Supplied, Permit Ref: 01m/638, Permit Version: 2, Effective Date: 1st January 1995, Issued Date: Not Supplied, Revocation Date: Not Supplied, Discharge Type: Trade Discharge - Process Water, Discharge Environment: Unknown, Receiving Water: Unknown, Status: Post National Rivers Authority Legislation where issue date > 31/08/1989, Positional Accuracy: Located by supplier to within 10m.	311m	SW
18	Operator: British Gas Transco, Property Type: Sewage Disposal Works - Other, Location: Stockport Gas Holder Station, Stockport, Greater Manchester, Authority: Environment Agency, North West Region, Catchment Area: Not Given, Permit Ref: 01m/638, Permit Version: 1, Effective Date: 1st April 1991, Issued Date: Not Supplied, Revocation Date: 31st December 1994, Discharge Type: Non Water Company (Private) Sewage, Discharge Environment: Unknown, Receiving Water: Unknown, Status: Authorisation revoked, Positional Accuracy: Located by supplier to within 10m.	311m	SW
19	Operator: United Utilities Water Plc, Property Type: Sewage Disposal Works - Water Company, Location: Newbridge Lane Portwood, Portwood, Greater Manchester, Authority: Environment Agency, North West Region, Catchment Area: Not Given, Permit Ref: 01STK0086, Permit Version: 1, Effective Date: 1st January 1995, Issued Date: Not Supplied, Revocation Date: 1st January 1995, Discharge Type: Public Sewage: Storm Sewage Overflow, Discharge Environment: Freshwater Stream/River, Receiving Water: River Goyt, Status: Consent revoked or revised: New Consent issued (Section 37(1)), Positional Accuracy: Located by supplier to within 100m.	340m	E
20	Operator: United Utilities Water Plc, Property Type: Sewage Disposal Works - Water Company, Location: Newbridge Lane Portwood, Portwood, Greater Manchester, Authority: Environment Agency, North West Region, Catchment Area: Not Given, Permit Ref: 016982657, Permit Version: 1, Effective Date: 30th September 1994, Issued Date: Not Supplied, Revocation Date: Not Supplied, Discharge Type: Public Sewage: Storm Sewage Overflow, Discharge Environment: Freshwater Stream/River, Receiving Water: River Goyt, Status: Post National Rivers Authority Legislation where issue date > 31/08/1989, Positional Accuracy: Located by supplier to within 10m.	341m	E

Map ID	Details	Distance	Direction
21	Operator: United Utilities Water Plc, Property Type: Sewage Disposal Works - Water Company, Location: Newbridge Lane Portwood, Portwood, Greater Manchester, Authority: Environment Agency, North West Region, Catchment Area: Not Given, Permit Ref: 01STK0087, Permit Version: 1, Effective Date: 1st January 1995, Issued Date: Not Supplied, Revocation Date: 1st January 1995, Discharge Type: Public Sewage: Storm Sewage Overflow, Discharge Environment: Freshwater Stream/River, Receiving Water: River Goyt, Status: Consent revoked or revised: New Consent issued (Section 37(1)), Positional Accuracy: Located by supplier to within 10m.	341m	E
22	Operator: United Utilities Water Plc, Property Type: Sewage Disposal Works - Water Company, Location: Newbridge Lane Portwood, Portwood, Greater Manchester, Authority: Environment Agency, North West Region, Catchment Area: Not Given, Permit Ref: 016982656, Permit Version: 1, Effective Date: 30th September 1994, Issued Date: Not Supplied, Revocation Date: Not Supplied, Discharge Type: Public Sewage: Storm Sewage Overflow, Discharge Environment: Freshwater Stream/River, Receiving Water: River Goyt, Status: Post National Rivers Authority Legislation where issue date > 31/08/1989, Positional Accuracy: Located by supplier to within 100m.	341m	E
23	Operator: Peel Investments (Uk) Ltd, Property Type: Recreational & Cultural, Location: Peel Centre Swo Non-Food Retailing Park, Great Portwood Street, Stockport, Greater Manchester, Authority: Environment Agency, North West Region, Catchment Area: Not Given, Permit Ref: 016991182, Permit Version: 1, Effective Date: 8th September 1987, Issued Date: Not Supplied, Revocation Date: 1st July 1991, Discharge Type: Discharge Of Other Matter-Surface Water, Discharge Environment: Freshwater Stream/River, Receiving Water: River Goyt, Status: Authorisation revoked, Positional Accuracy: Located by supplier to within 100m.	421m	SW
24	Operator: Metropolitan Borough Of Stockport, Property Type: Sewage Disposal Works - Other, Location: Vernon Park Swo, Newbridge Lane, Stockport, Greater Manchester, Authority: Environment Agency, North West Region, Catchment Area: Not Given, Permit Ref: 016991390, Permit Version: 1, Effective Date: 1st April 1993, Issued Date: Not Supplied, Revocation Date: 21st May 1993, Discharge Type: Discharge Of Other Matter-Surface Water, Discharge Environment: Freshwater Stream/River, Receiving Water: River Goyt, Status: Authorisation revoked, Positional Accuracy: Located by supplier to within 100m.	455m	E

## Hazardous Sites

### Control of Major Accident Hazard Sites (COMAH)

25	Name: National Grid Gas Plc, Location: Stockport Holder Station, Great Portwood Street, Stockport, Cheshire, Sk1 2HQ, Reference: Not Supplied, Type: Lower Tier, Status: Active, Positional Accuracy: Manually positioned to the address or location.	302m	SW
26	Name: Transco Plc, Location: Great Portwood Street, Stockport, STOCKPORT, Cheshire, SK1 2HQ, Reference: 1024589, Type: Lower Tier, Status: Active, Positional Accuracy: Manually positioned to the address or location.	309m	SW

### Notification of Installations Handling Hazardous Substances (NIHHS)

27	Name: Transco., Location: Stockport Gas Holder Station, Great Portwood Street, STOCKPORT, Cheshire, SK1 2HQ, Status: Active, Positional Accuracy: Manually positioned to the address or location.	312m	SW
----	---	------	----

### Planning Hazardous Substance Consents

28	Name: Transco, Location: Great Portwood Street, Stockport, Greater Manchester, Sk1 2jd, Authority: Stockport Metropolitan Borough Council, Environment and Economic Development, Application Ref: DC/003804, Hazardous Substance: Liquefied extremely flammable gas (including LPG) and natural gas (whether liquefied or not), Maximum Quantity: 0 Liquefied extremely flammable gas (including LPG) and natural gas (whether liquefied or not), Application Date: 23rd February 2001, Decision: Deemed Consent Granted, Positional Accuracy: Located by supplier to within 10m.	303m	SW
----	---	------	----

<b>Map ID</b>	<b>Details</b>	<b>Distance</b>	<b>Direction</b>
29	Name: British Gas Plc, Location: Great Portwood Street, STOCKPORT, Greater Manchester, SK1 2JD, Authority: Stockport Metropolitan Borough Council, Environment and Economic Development, Application Ref: J56641, Hazardous Substance: Liquefied extremely flammable gas (including LPG) and natural gas (whether liquefied or not), Maximum Quantity: 40 Liquefied extremely flammable gas (including LPG) and natural gas (whether liquefied or not), Application Date: 14th October 1992, Decision: Deemed Consent Granted, Positional Accuracy: Located by supplier to within 10m.	310m	SW

## **Contraventions**

### Local Authority Pollution Prevention and Control Enforcements

30	Location: Mersey Street, Stockport, Merseyside, Sk1 4aa, Pollution Incident: Air Pollution Control Enforcement Notice, Reference: EPA043, Details: Not Supplied, Date Issued: Not Supplied, Date Enforced: Not Supplied, Positional Accuracy: Manually positioned to the road within the address or location.	24m	S
----	---	-----	---

# Waste

Map ID	Details	Distance	Direction
--------	---------	----------	-----------

## Waste/Landfill Sites

### Local Authority Landfill Coverage

Stockport Metropolitan Borough Council - Has not been able to supply Landfill data

### BGS Recorded Landfill Sites

31	Name: Woodhall Tip, Location: Tame Valley, STOCKPORT, Gt Manchester, Authority: British Geological Survey, National Geoscience Information Service, Ground Water: Information not available, Surface Water: Information not available, Geology: N/A, Positional Accuracy: Positioned by the supplier, Boundary Accuracy: Moderate.	527m	NW
----	--	------	----

32	Name: Grimes Bottom Tip, Location: Tane St, STOCKPORT, Gt Manchester, Authority: British Geological Survey, National Geoscience Information Service, Ground Water: Information not available, Surface Water: Information not available, Geology: N/A, Positional Accuracy: Positioned by the supplier, Boundary Accuracy: Moderate.	670m	NW
----	---	------	----

### Licensed Waste Management Facilities (Locations)

39	Licence Number: 53452, Location: Borron Street, Portwood, Stockport, Cheshire, SK1 2JD, Operator: North West Water Ltd, Operator Location: Not Supplied, Authority: Environment Agency - North West Region, South Area, Site Category: Special Waste Transfer Stations, Licence Status: Surrendered, Issued Date: 11th June 1999, Last Modified: Not Supplied, Expiry Date: Not Supplied, Suspended Date: Not Supplied, Revoked Date: Not Supplied, Surrendered Date: 19th June 2001, IPPC Reference: Not Supplied, Positional Accuracy: Located by supplier to within 10m.	0m	NE
----	---	----	----

40	Licence Number: 50318, Location: Borough Park, Stanley Street, Stockport, Cheshire, SK1 2NE, Operator: Motor Move ( U K ) Ltd, Operator Location: Not Supplied, Authority: Environment Agency - North West Region, South Area, Site Category: End of Life Vehicles, Licence Status: Issued, Issued Date: 21st December 2004, Last Modified: Not Supplied, Expiry Date: Not Supplied, Suspended Date: Not Supplied, Revoked Date: Not Supplied, Surrendered Date: Not Supplied, IPPC Reference: Not Supplied, Positional Accuracy: Located by supplier to within 10m.	480m	SW
----	--	------	----

41	Licence Number: 50465, Location: Unit 1, Water Street, Stockport, Cheshire, SK1 2BL, Operator: Data I Q Recycling Ltd, Operator Location: Not Supplied, Authority: Environment Agency - North West Region, South Area, Site Category: Physical Treatment Facilities, Licence Status: Surrendered, Issued Date: 6th November 2006, Last Modified: Not Supplied, Expiry Date: Not Supplied, Suspended Date: Not Supplied, Revoked Date: Not Supplied, Surrendered Date: 15th September 2008, IPPC Reference: Not Supplied, Positional Accuracy: Located by supplier to within 10m.	620m	W
----	--	------	---

	Licence Number: 101070, Location: Unit 1, Water Street, Stockport, Lancs, SK1 2BL, Operator: K M D Recycling Ltd, Operator Location: Not Supplied, Authority: Environment Agency - North West Region, South Area, Site Category: WEEE treatment facility, Licence Status: Issued, Issued Date: 23rd October 2009, Last Modified: Not Supplied, Expiry Date: Not Supplied, Suspended Date: Not Supplied, Revoked Date: Not Supplied, Surrendered Date: Not Supplied, IPPC Reference: Not Supplied, Positional Accuracy: Located by supplier to within 100m.	681m	W
--	--	------	---

### Registered Landfill Sites



Map ID	Details	Distance	Direction
42	<p>Licence Holder: Alfred Mc Alpine Construction Ltd, Licence Reference: 00472/87, Site Location: Adj.M63 Roundabout, Portwood, Stockport, Cheshire, Easting: 390300, Northing: 391100, Operator Location: Site Office, Ashton Road, Bredbury, Stockport, Cheshire, Authority: Environment Agency - North West Region, South Area, Site Category: Landfill, Maximum Input Rate: Large (Equal to or greater than 75,000 and less than 250,000 tonnes per year), Waste Source Restrictions: Waste produced/controlled by licence holder, Dated: 1st August 1987, Preceded By Licence: Not Given, Superseded By Licence: Not Given, Positional Accuracy: Manually positioned to the road within the address or location, Boundary Accuracy: Not Applicable, Authorised Waste: 1.Ceramic Materials, 2.Constr'N Ind. Wastes Containing Only, 3.Fibreglass, 4.Glass, 5.Metals, 6.Plastics, 7.Similar Non Leachate Forming Materials, 8.Soil,Clay,Sand, 9.Stone,Brick,Concrete,Slate, 10.Wood, Prohibited Waste: 1.Animal Flesh, 2.Chemical Waste Of Any Nature, 3.Foodstuffs, 4.Paper/Cardboard, 5.Plasterboard, 6.Sawdust, 7.Textiles, 8.Vegetable Matter, 9.Waste Forming Polluting Leachate, 10.Waste In Liquid Or Sludge Form.</p> <p>Registered Waste Transfer Sites</p>	49m	NW
43	<p>Licence Holder: North West Water Ltd, Licence Reference: 01144, Site Location: Borrow Street, Portwood, Stockport, Cheshire, Operator Location: Dawson House, Liverpool Road, Great Sankey, Warrington, Cheshire, Wa5 3lw, Authority: Environment Agency - North West Region, South Area, Site Category: Transfer, Maximum Input Rate: Small (Equal to or greater than 10,000 and less than 25,000 tonnes per year), Waste Source Restrictions: Waste produced/controlled by licence holder, Dated: 11th June 1999, Preceded By Licence: Not Given, Superseded By Licence: Not Given, Positional Accuracy: Manually positioned to the address or location, Boundary Accuracy: Not Supplied, Authorised Waste: 1.Brick, Stone, Concrete, 2.Cement Bonded Asbestos Pipe/Fittings, 3.Excav.Soil, Clay,Silt, Sand, 4.Ferrous Metal Pipe/Fittings, 5.Industrial Non-Hazardous Waste - Comprising, 6.Maximum Waste Permitted By Licence, 7.Plastic Pipe, Prohibited Waste: 1.Contaminated Soil, 2.Leachate Forming Wastes, 3.Other Waste/Waste Not Otherwise Specified.</p>	0m	N
44	<p>Licence Holder: British Gas Plc, Licence Reference: 00982, Site Location: Newbridge Lane, Stockport, Cheshire, Operator Location: As Site Address, Authority: Environment Agency - North West Region, South Area, Site Category: Transfer, Maximum Input Rate: Undefined, Waste Source Restrictions: Waste produced/controlled by licence holder, Dated: 1st June 1995, Preceded By Licence: Not Given, Superseded By Licence: Not Given, Positional Accuracy: Manually positioned to the address or location, Boundary Accuracy: Not Supplied, Authorised Waste: 1.Including Special Wastes, 2.Licensed Wastes Not To Hand, Prohibited Waste: N/A.</p>	306m	SW
45	<p>Licence Holder: Supertune Automotive Ltd, Licence Reference: 00606/90, Site Location: Richard Street, off Portwood Street, STOCKPORT, Cheshire, SK1 2AX, Operator Location: Oldham Central Trading Park, Coulton Close, OLDHAM, Lancashire, OL1 4EB, Authority: Environment Agency - North West Region, South Area, Site Category: Transfer, Maximum Input Rate: Undefined, Waste Source Restrictions: No known restriction on source of waste, Dated: 1st September 1990, Preceded By Licence: Not Given, Superseded By Licence: Not Given, Positional Accuracy: Manually positioned to the address or location, Boundary Accuracy: Not Supplied, Authorised Waste: 1.Hydrocarbons, 2.Oxygen Containing Organic Compounds, 3.Paint Waste \$, Prohibited Waste: N/A.</p> <p>Historical Landfill Sites</p>	431m	W
33	<p>Licence Holder: Not Supplied, Location: Portwood, Stockport, Name: Baron Street, Operator Location: Not Supplied, Boundary Accuracy: As Supplied, Provider Reference: EAhLD17857, First Input Date: Not Supplied, Last Input Date: Not Supplied, Specified Waste Type: Not Supplied, EA Waste Ref: Not Supplied, Regis Ref: Not Supplied, WRC Ref: Not Supplied, BGS Ref: Not Supplied, Other Ref: WML/1144</p>	0m	-

<b>Map ID</b>	<b>Details</b>	<b>Distance</b>	<b>Direction</b>
34	Licence Holder: Alfred McAlpine Construction Limited, Location: Portwood, Stockport, Name: Land adjacent to M63 Roundabout, Operator Location: Not Supplied, Boundary Accuracy: As Supplied, Provider Reference: EAHLD16782, First Input Date: 31st December 1987, Last Input Date: 31st December 1990, Specified Waste Type: Deposited Waste included Inert and Industrial Waste, EA Waste Ref: Not Supplied, Regis Ref: Not Supplied, WRC Ref: 4200/9350, BGS Ref: Not Supplied, Other Ref: RD/LIC/472/87, J022	205m	NW
35	Licence Holder: Stockport Metropolitan Borough Council, Location: Tiviot Dale, Grimesbottom. Greater Manchester, Name: North Woodhall, Operator Location: Not Supplied, Boundary Accuracy: As Supplied, Provider Reference: EAHLD16754, First Input Date: 31st December 1960, Last Input Date: 31st December 1973, Specified Waste Type: Deposited Waste included Inert, Industrial, Commercial, Household and Special Waste, and Liquid Sludge, EA Waste Ref: Not Supplied, Regis Ref: Not Supplied, WRC Ref: 4200/9666, BGS Ref: Not Supplied, Other Ref: J041	337m	NW
36	Licence Holder: Stockport Metropolitan Borough Council, Location: Portwood, Greater Manchester, Name: Warth Meadow, Operator Location: Not Supplied, Boundary Accuracy: As Supplied, Provider Reference: EAHLD16763, First Input Date: 31st December 1950, Last Input Date: 31st December 1978, Specified Waste Type: Deposited Waste included Inert, Industrial, Commercial and Household Waste, EA Waste Ref: Not Supplied, Regis Ref: Not Supplied, WRC Ref: 4200/9691, BGS Ref: Not Supplied, Other Ref: RD/LIC/469/87, J046	344m	E
37	Licence Holder: Stockport Metropolitan Borough Council, Location: Tiviot Dale, Grimesbottom. Greater Manchester, Name: North Woodhall, Operator Location: Not Supplied, Boundary Accuracy: As Supplied, Provider Reference: EAHLD16755, First Input Date: 31st December 1935, Last Input Date: 1st December 1978, Specified Waste Type: Deposited Waste included Inert, Industrial, Commercial, Household and Special Waste, and Liquid Sludge, EA Waste Ref: Not Supplied, Regis Ref: Not Supplied, WRC Ref: 4200/9673, BGS Ref: 2926, Other Ref: J041	492m	NW
38	Licence Holder: Not Supplied, Location: South of Tiviot Way, Stockport, Greater Manchester, Name: Grimesbottom, Operator Location: Not Supplied, Boundary Accuracy: As Supplied, Provider Reference: EAHLD16772, First Input Date: Not Supplied, Last Input Date: 13th January 1972, Specified Waste Type: Deposited Waste included Inert, Industrial and Commercial Waste, and Liquid Sludge, EA Waste Ref: Not Supplied, Regis Ref: Not Supplied, WRC Ref: Not Supplied, BGS Ref: 2837, Other Ref: J042	504m	NW
	Licence Holder: Not Supplied, Location: Portwood, Greater Manchester, Greater Manchester, Name: Warth Meadow, Operator Location: Not Supplied, Boundary Accuracy: As Supplied, Provider Reference: EAHLD16794, First Input Date: Not Supplied, Last Input Date: Not Supplied, Specified Waste Type: Not Supplied, EA Waste Ref: Not Supplied, Regis Ref: Not Supplied, WRC Ref: Not Supplied, BGS Ref: Not Supplied, Other Ref: J046a	657m	E

## Current Land Use

Map ID	Details	Distance	Direction
<b>Current Potentially Contaminative Uses</b>			
Contemporary Trade Directory Entries			
50	Gas Suppliers, Name: Cheshire Bottled Gas Status: Active, Location: Mersey St, Stockport, Cheshire, SK1 2HX, Positional Accuracy: Manually positioned to the road within the address or location.	7m	S
51	Car Dealers - Used, Name: Uk Motor Trader Status: Inactive, Location: Viking House, Borrton St, Stockport, Cheshire, SK1 2JD, Positional Accuracy: Manually positioned to the road within the address or location.	8m	NW
52	Garage Services, Name: A & M Donaldson Status: Inactive, Location: Palmer Mill, Mersey St, Stockport, Cheshire, SK1 2JQ, Positional Accuracy: Manually positioned to the road within the address or location.	8m	SE
53	Mot Testing Centres, Name: Mersey Street Garage Status: Inactive, Location: Mersey St, Stockport, Cheshire, SK1 2HX, Positional Accuracy: Manually positioned to the road within the address or location.	9m	S
54	Garage Services, Name: Mersey Street Garage Status: Active, Location: Mersey St, Stockport, Cheshire, SK1 2HX, Positional Accuracy: Manually positioned to the road within the address or location.	9m	S
55	PVC-U Products - Manufacturers & Suppliers, Name: Vale Window Co Ltd Status: Active, Location: Browpark House, Borrton Street, Stockport, Cheshire, SK1 2JD, Positional Accuracy: Automatically positioned to the address.	19m	NW
56	Glass Products - Manufacturers, Name: Cheadle Glass Co Ltd Status: Active, Location: Borrton Street, Stockport, Cheshire, SK1 2JD, Positional Accuracy: Automatically positioned to the address.	20m	E
57	Hardware, Name: B & F Status: Inactive, Location: 1st Floor, Vernon Mill, Mersey Street, Portwood, Stockport, Cheshire, SK1 2HX, Positional Accuracy: Manually positioned to the address or location.	33m	S
58	Air Conditioning & Refrigeration Contractors, Name: Comfort Cooling Status: Inactive, Location: Unit 21, Vernon Mill, Mersey St, Stockport, Cheshire, SK1 2HX, Positional Accuracy: Manually positioned to the address or location.	33m	S
59	Car Accessories Manufacturers, Name: Sai Baba Status: Active, Location: Unit 21A-26Q, Vernon Mill, Mersey St, Stockport, Cheshire, SK1 2HX, Positional Accuracy: Manually positioned to the address or location.	33m	S
60	Engineering Machine Services, Name: Steve Bennett Status: Active, Location: Unit 18, Vernon Mill, Mersey St, Stockport, Cheshire, SK1 2HX, Positional Accuracy: Manually positioned to the address or location.	33m	S
61	Pumps - Sales, Servicing & Repairs, Name: 3a Status: Active, Location: Unit 28d, Vernon Mill, Mersey St, Stockport, Cheshire, SK1 2HX, Positional Accuracy: Manually positioned to the address or location.	33m	S
62	Printers, Name: Mike Eyre Status: Active, Location: Vernon Mill, Mersey Street, Stockport, Cheshire, SK1 2HX, Positional Accuracy: Automatically positioned to the address.	34m	S
63	Printers, Name: Reams Status: Inactive, Location: Vernon Mill, Mersey Street, Stockport, Cheshire, SK1 2HX, Positional Accuracy: Automatically positioned to the address.	34m	S
64	Printers, Name: L D P Ltd Status: Inactive, Location: Unit 26s, Vernon Mill, Mersey Street, Stockport, Cheshire, SK1 2HX, Positional Accuracy: Automatically positioned to the address.	34m	S

<b>Map ID</b>	<b>Details</b>	<b>Distance</b>	<b>Direction</b>
65	Air Conditioning Equipment & Systems, Name: Air Supplies Status: Inactive, Location: Unit 26l, Vernon Mill, Mersey Street, Stockport, Cheshire, SK1 2HX, Positional Accuracy: Automatically positioned to the address.	34m	S
66	Car Body Repairs, Name: David Holmes Accident Repair Centre Status: Active, Location: Mersey Street, Stockport, Cheshire, SK1 2HX, Positional Accuracy: Automatically positioned to the address.	34m	S
67	Clothing & Fabrics - Manufacturers, Name: Havok Design Status: Inactive, Location: Unit 26n, Vernon Mill, Mersey Street, Stockport, Cheshire, SK1 2HX, Positional Accuracy: Automatically positioned to the address.	34m	S
68	Joinery Manufacturers, Name: Acorn Windows Status: Inactive, Location: Unit 18, Vernon Mill, Mersey Street, Stockport, Cheshire, SK1 2HX, Positional Accuracy: Automatically positioned to the address.	34m	S
69	Garage Services, Name: Car Care Svs Status: Inactive, Location: Unit 30, Vernon Mill, Mersey Street, Stockport, Cheshire, SK1 2HX, Positional Accuracy: Automatically positioned to the address.	34m	S
70	Metal Finishing Services, Name: Reddish Electroplating Status: Active, Location: Mersey Street, Stockport, Cheshire, SK1 2HX, Positional Accuracy: Automatically positioned to the address.	34m	S
71	Printers, Name: Photo To Canvas Status: Active, Location: Unit 207, Vernon Mill, Stockport, Cheshire, SK1 2HX, Positional Accuracy: Manually positioned to the address or location.	34m	S
72	Engine Rebuilding & Reconditioning, Name: Quasar Engineering Status: Active, Location: Unit 2, Vernon Mill, Mersey Street, Stockport, Cheshire, SK1 2HX, Positional Accuracy: Automatically positioned to the address.	34m	S
73	Joinery Manufacturers, Name: R W Joinery Ltd Status: Active, Location: Unit 26, Mersey Street, Stockport, Cheshire, SK1 2HX, Positional Accuracy: Automatically positioned to the address.	34m	S
74	Car Body Repairs, Name: A C Status: Active, Location: Mersey Street, Stockport, Cheshire, SK1 2HX, Positional Accuracy: Automatically positioned to the address.	34m	S
75	Furniture Manufacturers - Home & Office, Name: P & S Sharples Status: Inactive, Location: Unit 3b, Vernon Mill, Mersey Street, Stockport, Cheshire, SK1 2HX, Positional Accuracy: Automatically positioned to the address.	34m	S
76	Commercial Vehicle Dealers, Name: J & S Commercial Van Sales Status: Inactive, Location: Unit 30, Vernon Mill, Mersey Street, Stockport, Cheshire, SK1 2HX, Positional Accuracy: Automatically positioned to the address.	34m	S
77	Telecommunications Equipment & Systems, Name: Surecomm Telecommunications Status: Inactive, Location: Unit 22, Vernon Mill, Mersey Street, Stockport, Cheshire, SK1 2HX, Positional Accuracy: Manually positioned to the address or location.	34m	S
78	Engine Rebuilding & Reconditioning, Name: Engine Co Services Ltd Status: Active, Location: Unit 30, Vernon Mill, Mersey Street, Stockport, Cheshire, SK1 2HX, Positional Accuracy: Automatically positioned to the address.	34m	S
79	Fireplaces & Mantelpieces, Name: Flickers Fire Surrounds Status: Inactive, Location: Unit 26a, Vernon Mill, Mersey Street, Stockport, Cheshire, SK1 2HX, Positional Accuracy: Automatically positioned to the address.	34m	S
80	Rubber & Plastic Products - Manufacturers, Name: Robant Services Ltd Status: Active, Location: Unit 24, Mersey Street, Stockport, Cheshire, SK1 2HX, Positional Accuracy: Automatically positioned to the address.	34m	S
81	Clothing & Fabrics - Manufacturers, Name: Lewing Ltd Status: Inactive, Location: Borrton St, Stockport, Cheshire, SK1 2JB, Positional Accuracy: Manually positioned to the address or location.	40m	W

<b>Map ID</b>	<b>Details</b>	<b>Distance</b>	<b>Direction</b>
82	Sheet Metal Work, Name: J E M Sheet Metal & Engineering Ltd Status: Active, Location: Borrton Street, Stockport, Cheshire, SK1 2JD, Positional Accuracy: Automatically positioned to the address.	43m	SW
83	Garage Services, Name: B & M World Ltd Status: Active, Location: 5, Carrington Road, Stockport, Cheshire, SK1 2JX, Positional Accuracy: Automatically positioned to the address.	112m	NE
84	Garage Services, Name: Ian Rhodes Status: Active, Location: Romiley Street, Stockport, Cheshire, SK1 2LB, Positional Accuracy: Automatically positioned to the address.	119m	NE
85	Electrical Goods Sales, Manufacturers & Wholesalers, Name: Currys Status: Inactive, Location: Unit 9, Peel Centre, Great Portwood Street, Stockport, Cheshire, SK1 2HD, Positional Accuracy: Automatically positioned to the address.	133m	W
86	Car Dealers, Name: Evans Halshaw Status: Active, Location: 1, St. Marys Way, Stockport, Cheshire, SK1 2HY, Positional Accuracy: Automatically positioned to the address.	137m	S
87	Car Dealers, Name: Horns Of Stockport (Citroen) Status: Inactive, Location: 1, St. Marys Way, Stockport, Cheshire, SK1 2HY, Positional Accuracy: Automatically positioned to the address.	137m	S
88	Garden Ornament Manufacturers, Name: P & B Status: Inactive, Location: Unit 16, Carrington Road, Stockport, Cheshire, SK1 2JT, Positional Accuracy: Automatically positioned to the address.	151m	E
89	Sheet Metal Working Equipment & Supplies, Name: Boxer Design & Manufacturing Ltd Status: Inactive, Location: Unit 11, Carrington Road, Stockport, Cheshire, SK1 2JT, Positional Accuracy: Automatically positioned to the address.	151m	E
90	Wrought Ironwork, Name: Alfa Products Status: Inactive, Location: Unit 10A, Carrington Rd, Stockport, Cheshire, SK1 2JT, Positional Accuracy: Manually positioned to the road within the address or location.	151m	NE
91	Garage Services, Name: S P R Autos Status: Active, Location: Unit 16, Carrington Road, STOCKPORT, Cheshire, SK1 2JT, Positional Accuracy: Automatically positioned to the address.	151m	E
92	Sheet Metal Work, Name: Oliver Equipment Ltd Status: Inactive, Location: Carrington Road, Stockport, Cheshire, SK1 2JT, Positional Accuracy: Automatically positioned to the address.	151m	E
93	Sheet Metal Working Equipment & Supplies, Name: Bulldog Industrial Holdings Ltd Status: Active, Location: Carrington Road, Stockport, Cheshire, SK1 2JT, Positional Accuracy: Automatically positioned to the address.	151m	E
94	Car Body Repairs, Name: J D Motors Status: Active, Location: Unit 10, Carrington Road, Stockport, Cheshire, SK1 2JT, Positional Accuracy: Automatically positioned to the address.	154m	E
95	Plastics - Injection Moulding, Name: Wheatley Plastics Ltd Status: Active, Location: Reynolds Mill, Newbridge Lane, Stockport, Cheshire, SK1 2NR, Positional Accuracy: Automatically positioned to the address.	161m	S
96	Commercial Vehicle Servicing, Repairs, Parts & Accessories, Name: Cheshire Vans Status: Active, Location: 21, Carrington Road, Stockport, Cheshire, SK1 2JX, Positional Accuracy: Automatically positioned to the address.	166m	NE
97	Car Breakers & Dismantlers, Name: Premier Auto Services Status: Inactive, Location: 21, Carrington Road, Stockport, Cheshire, SK1 2JX, Positional Accuracy: Automatically positioned to the address.	166m	NE
98	Wrought Ironwork, Name: Abbey Gates Status: Inactive, Location: 10a Portwood Ind Est, Offerton St, Stockport, Cheshire, SK1 2LB, Positional Accuracy: Manually positioned within the geographical locality.	177m	E

<b>Map ID</b>	<b>Details</b>	<b>Distance</b>	<b>Direction</b>
99	Car Dealers - Used, Name: Carrington Cars Status: Active, Location: Carrington Rd, Stockport, Cheshire, SK1 2JT, Positional Accuracy: Manually positioned to the road within the address or location.	189m	E
100	Precision Engineers, Name: Manufax Engineering Ltd Status: Active, Location: Cromer Street, Stockport, Cheshire, SK1 2NP, Positional Accuracy: Automatically positioned to the address.	204m	S
101	Precision Engineers, Name: Nelson Tool Co Ltd Status: Active, Location: Stringer Street, Stockport, Cheshire, SK1 2NZ, Positional Accuracy: Automatically positioned to the address.	246m	S
102	Mot Testing Centres, Name: Steve Davis Status: Active, Location: Newbridge La, Stockport, Cheshire, SK1 2NX, Positional Accuracy: Manually positioned to the road within the address or location.	258m	S
103	Paint Spraying Equipment & Accessories, Name: Autopaint (International) Ltd Status: Inactive, Location: 91, Great Portwood Street, Stockport, Cheshire, SK1 2AS, Positional Accuracy: Automatically positioned to the address.	261m	W
104	Garage Services, Name: Newbridge Auto Centre Status: Inactive, Location: 171, Newbridge Lane, Stockport, Cheshire, SK1 2NX, Positional Accuracy: Automatically positioned to the address.	272m	SW
105	Garage Services, Name: Amazing Sounds Status: Active, Location: 171, Newbridge Lane, Stockport, Cheshire, SK1 2NX, Positional Accuracy: Automatically positioned to the address.	272m	SW
106	Garage Services, Name: Newbridge Lane Exhausts & Tyres Status: Inactive, Location: 171, Newbridge Lane, Stockport, Cheshire, SK1 2NX, Positional Accuracy: Automatically positioned to the address.	272m	SW
107	Commercial Cleaning Services, Name: Northern Contract Cleaners Status: Inactive, Location: 14, Carrington Road, Stockport, Cheshire, SK1 2QE, Positional Accuracy: Automatically positioned to the address.	276m	E
108	Garage Services, Name: Cheshire German Specialist Status: Active, Location: Unit 4 & 5, Offerton Street, Stockport, Cheshire, SK1 2QE, Positional Accuracy: Manually positioned within the geographical locality.	276m	E
109	Textile Manufacturing, Name: William Ayrton & Co Ltd Status: Inactive, Location: Peter St, Stockport, Cheshire, SK1 2AU, Positional Accuracy: Manually positioned to the road within the address or location.	276m	W
110	Tyre Dealers, Name: Tyre Zone Status: Active, Location: 3, Werneth Street, Stockport, Cheshire, SK1 2QF, Positional Accuracy: Automatically positioned to the address.	287m	E
111	Electrical Goods Sales, Manufacturers & Wholesalers, Name: P R G Powerhouse Status: Inactive, Location: Unit 2, Peel Centre, Great Portwood Street, Stockport, Cheshire, SK1 2HH, Positional Accuracy: Automatically positioned to the address.	337m	SW
112	Boilers - Servicing, Replacements & Repairs, Name: Abacus Plumbing & Heating Services Status: Active, Location: 23, Hanson Mews, Stockport, Cheshire, SK1 4HS, Positional Accuracy: Automatically positioned to the address.	338m	SE
113	Mot Testing Centres, Name: Leigh Autos Status: Active, Location: Unit 1-2, New Zealand Rd, Stockport, Cheshire, SK1 4AG, Positional Accuracy: Manually positioned within the geographical locality.	369m	S
114	Electrical Goods Sales, Manufacturers & Wholesalers, Name: Comet Group Plc Status: Active, Location: Unit 3, Peel Centre, Great Portwood Street, Stockport, Cheshire, SK1 2HJ, Positional Accuracy: Automatically positioned to the address.	373m	SW
115	Electrical Goods Sales, Manufacturers & Wholesalers, Name: Comet Group Plc Status: Active, Location: Unit 4b, Peel Centre, Great Portwood Street, Stockport, Cheshire, SK1 2HH, Positional Accuracy: Automatically positioned to the address.	373m	SW

<b>Map ID</b>	<b>Details</b>	<b>Distance</b>	<b>Direction</b>
116	Car Dealers, Name: Bwc Status: Inactive, Location: Richard St, Stockport, Cheshire, SK1 2AX, Positional Accuracy: Manually positioned to the road within the address or location.	398m	W
117	Photocopiers, Name: Ikon Office Solutions Plc Status: Active, Location: Unit 3, New Zealand Road, Stockport, Cheshire, SK1 4AG, Positional Accuracy: Automatically positioned to the address.	400m	S
118	Generators - Sales & Service, Name: Ingram Installations Ltd Status: Inactive, Location: New Zealand Road, Stockport, Cheshire, SK1 4AG, Positional Accuracy: Automatically positioned to the address.	400m	S
119	Fencing Manufacturers, Name: Able Fencing Ltd Status: Inactive, Location: Unit C-D, Richard St, Stockport, Cheshire, SK1 2AX, Positional Accuracy: Manually positioned to the road within the address or location.	400m	W
120	Car Dealers, Name: T M C Motor Co Status: Active, Location: Unit 3, Richard Street, Stockport, Cheshire, SK1 2AX, Positional Accuracy: Automatically positioned to the address.	412m	W
121	Car Dealers - Used, Name: Raymond Johnson Status: Inactive, Location: Unit 3, Richard St, Stockport, Cheshire, SK1 2AX, Positional Accuracy: Manually positioned to the address or location.	412m	W
122	Boiler Manufacturers, Name: Dash Energy Services Status: Inactive, Location: Unit 3, Richard Street, Stockport, Cheshire, SK1 2AX, Positional Accuracy: Automatically positioned to the address.	412m	W
123	Car Body Repairs, Name: Impact Smart Repair Systems Status: Inactive, Location: Unit 4, Richard St, Stockport, Cheshire, SK1 2AX, Positional Accuracy: Manually positioned to the address or location.	417m	W
124	Coal & Smokeless Fuel Merchants & Distributors, Name: J R Eckersley Status: Inactive, Location: Hanson Mews, Stockport, Cheshire, SK1 4HS, Positional Accuracy: Manually positioned to the road within the address or location.	423m	SE
125	Tyre Dealers, Name: Ian Riley Tyres & Exhausts Ltd Status: Inactive, Location: Unit 1, New Zealand Road, Stockport, Cheshire, SK1 4AG, Positional Accuracy: Automatically positioned to the address.	437m	S
126	Tyre Dealers, Name: Tyre Mountain Status: Active, Location: Unit 1, New Zealand Road, Stockport, Cheshire, SK1 4AG, Positional Accuracy: Automatically positioned to the address.	437m	S
127	Washing Machines - Servicing & Repairs, Name: N Johnson (Est 1971) Status: Inactive, Location: 70, Brinnington Road, Stockport, Cheshire, SK1 2EX, Positional Accuracy: Automatically positioned to the address.	439m	NE
128	Car Body Repairs, Name: D L F Autos Ltd Status: Inactive, Location: Richard Street, Stockport, Cheshire, SK1 2AX, Positional Accuracy: Automatically positioned to the address.	440m	W
129	Garage Services, Name: B & I Motors Status: Inactive, Location: Richard Street, Stockport, Cheshire, SK1 2AX, Positional Accuracy: Automatically positioned to the address.	440m	W
130	Car Dealers - Used, Name: B & I Motors Status: Inactive, Location: Richard St, Stockport, Cheshire, SK1 2AX, Positional Accuracy: Manually positioned to the address or location.	440m	W
131	Knitwear Manufacturers & Wholesalers, Name: Rowlinson Knitwear Ltd Status: Active, Location: Woodbank Industrial Estate, Turncroft Lane, Stockport, Cheshire, SK1 4AR, Positional Accuracy: Automatically positioned to the address.	461m	S
132	Garage Services, Name: P C Autos Status: Inactive, Location: 8, Avenue Street, Stockport, Cheshire, SK1 2BZ, Positional Accuracy: Automatically positioned to the address.	462m	W

<b>Map ID</b>	<b>Details</b>	<b>Distance</b>	<b>Direction</b>
133	Cleaning Services - Commercial, Name: Alexander Cleaning Services Status: Inactive, Location: Turncroft House, 89, Turncroft Lane, Stockport, Cheshire, SK1 4AR, Positional Accuracy: Automatically positioned to the address.	471m	SE
134	Window Frame Manufacturers, Name: Leonardo Windows Ltd Status: Active, Location: Turncroft House, 89, Turncroft Lane, Stockport, Cheshire, SK1 4AR, Positional Accuracy: Manually positioned to the address or location.	471m	SE
135	Road Haulage Services, Name: Transcorp Status: Inactive, Location: Turncroft House, 89, Turncroft Lane, Stockport, Cheshire, SK1 4AR, Positional Accuracy: Manually positioned to the address or location.	471m	SE
136	Car Body Repairs, Name: S A Addinall Status: Inactive, Location: Unit 2, Woodbank Works, Turncroft La, Stockport, Cheshire, SK1 4AR, Positional Accuracy: Manually positioned within the geographical locality.	473m	S
137	Car Body Repairs, Name: Prestige Wedding Cars Status: Inactive, Location: Unit 24, Woodbank Works, Turncroft Lane, Stockport, Cheshire, SK1 4AB, Positional Accuracy: Manually positioned within the geographical locality.	475m	S
138	Wrought Ironwork, Name: Anvil The Status: Inactive, Location: 34, Newbridge Lane, Stockport, Cheshire, SK1 2NA, Positional Accuracy: Automatically positioned to the address.	481m	SW
139	Printers, Name: Gilmore Printers Ltd Status: Inactive, Location: Meadow Mill, Water Street, Stockport, Cheshire, SK1 2BX, Positional Accuracy: Automatically positioned to the address.	483m	NW
140	Joinery Manufacturers, Name: Mandley D J Status: Inactive, Location: Unit 2-1 Meadow Mill, Water St, Stockport, Cheshire, SK1 2BU, Positional Accuracy: Manually positioned to the address or location.	483m	NW
141	Window Frame Manufacturers, Name: A G P Windows Ltd Status: Inactive, Location: Unit 4-1b, Meadow Mill, Water Street, Stockport, Cheshire, SK1 2BU, Positional Accuracy: Automatically positioned to the address.	483m	NW
142	Clothing & Fabrics - Manufacturers, Name: Amarah Collection Manufacturing Status: Inactive, Location: Unit 4-1b, Meadow Mill, Water Street, STOCKPORT, Cheshire, SK1 2BU, Positional Accuracy: Automatically positioned to the address.	483m	NW
143	Antiques - Repairing & Restoring, Name: Antique Ceramic Restoration Status: Active, Location: Meadow Mill, Water St, Stockport, Cheshire, SK1 2BX, Positional Accuracy: Manually positioned to the address or location.	483m	NW
144	Sheet Metal Work, Name: Howell A G & Son Status: Inactive, Location: Meadow Mill, Water Street, Stockport, Cheshire, SK1 2BX, Positional Accuracy: Automatically positioned to the address.	483m	NW
145	French Polishing, Name: Vale Polishers Status: Active, Location: Unit 23, Meadow Mill, Water Street, Stockport, Cheshire, SK1 2BY, Positional Accuracy: Automatically positioned to the address.	483m	NW
146	Garden & Patio Furniture Manufacturers & Distributors, Name: Harvey'S Status: Inactive, Location: Meadow Mill, Water St, Stockport, Cheshire, SK1 2BY, Positional Accuracy: Manually positioned to the address or location.	483m	NW
147	Photocopiers, Name: Northwest Digital Status: Active, Location: Unit 19, Meadow Mill, Water St, Stockport, Cheshire, SK1 2BX, Positional Accuracy: Manually positioned to the address or location.	483m	NW
148	Office Furniture & Equipment, Name: Double D Office Furnishers Ltd Status: Inactive, Location: Unit G3, Meadow Mill, Water Street, Stockport, Cheshire, SK1 2BY, Positional Accuracy: Automatically positioned to the address.	483m	NW
149	Clothing & Fabrics - Manufacturers, Name: Scarlet Clothing Status: Inactive, Location: Meadow Mill, Water Street, Stockport, Cheshire, SK1 2BU, Positional Accuracy: Manually positioned to the address or location.	483m	NW



<b>Map ID</b>	<b>Details</b>	<b>Distance</b>	<b>Direction</b>
150	Photocopiers, Name: Northwest Digital Status: Inactive, Location: Unit G3, Meadow Mill, Water Street, Stockport, Cheshire, SK1 2BY, Positional Accuracy: Manually positioned to the address or location.	483m	NW
151	Joinery Manufacturers, Name: P & L Joinery Status: Inactive, Location: Unit G5, Meadow Mill, Water Street, Stockport, Cheshire, SK1 2BU, Positional Accuracy: Automatically positioned to the address.	483m	NW
152	T-Shirts, Name: Adprint Status: Inactive, Location: Unit 4-1b, Meadow Mill, Water Street, Stockport, Cheshire, SK1 2BU, Positional Accuracy: Automatically positioned to the address.	483m	NW
153	Joinery Manufacturers, Name: D J Mandley Status: Active, Location: Unit 1/7, Meadow Mill, Water Street, Stockport, Cheshire, SK1 2BU, Positional Accuracy: Manually positioned to the address or location.	483m	NW
154	Joinery Manufacturers, Name: P & L Joinery Manufacturing Ltd Status: Active, Location: Unit 2.2-3, Meadow Mill, Water Street, Stockport, Cheshire, SK1 2BU, Positional Accuracy: Automatically positioned to the address.	483m	NW
155	Photographic Processors, Name: Pro Digital Imaging Ltd Status: Inactive, Location: Meadow Mill, Water Street, Stockport, Cheshire, SK1 2BU, Positional Accuracy: Automatically positioned to the address.	483m	NW
156	Soft Furnishings - Manufacturers, Name: Peachey Products Status: Inactive, Location: Meadow Mill, Water Street, Stockport, Cheshire, SK1 2BU, Positional Accuracy: Automatically positioned to the address.	483m	NW
157	Musical Instrument - Manufacturers, Name: Tonetech Ltd Status: Active, Location: Meadow Mill, Water Street, Stockport, Cheshire, SK1 2BX, Positional Accuracy: Automatically positioned to the address.	483m	NW
158	Office Equipment Manufacturers & Distributors, Name: Delta Business Equipment Status: Inactive, Location: Unit G3, Meadow Mill, Water Street, Stockport, Cheshire, SK1 2BY, Positional Accuracy: Automatically positioned to the address.	483m	NW
159	Breakdown and Recovery, Name: Motor Move Recovery (Uk) Ltd Status: Active, Location: Borough Park, Stanley Street, Stockport, Cheshire, SK1 2NE, Positional Accuracy: Automatically positioned to the address.	494m	SW
160	Concrete Products, Name: Pickford Pre-Cast Concrete Status: Active, Location: Borough Park, Stanley Street, Stockport, Cheshire, SK1 2NE, Positional Accuracy: Automatically positioned to the address.	494m	SW
161	Road Haulage Services, Name: Frank Hoyle Ltd Status: Inactive, Location: Water Street, Stockport, Cheshire, SK1 2BL, Positional Accuracy: Automatically positioned to the address.	496m	W
<b>Fuel Station Entries</b>			
162	Name: Tesco Stockport Extra, Location: Tiviot Way, Stockport, Cheshire, SK1 2BT, Brand: Tesco Extra, Premises Type: Hypermarket, Status: Open, Positional Accuracy: Manually positioned to the address or location.	383m	NW
<b>Other Features</b>			
<b>Telecommunication Base Stations</b>			
163	Telecommunication Base Station, Location: Portwood, Stockwood, Cheshire, Mast Height (m): 9.	126m	W
164	Telecommunication Base Station, Location: Portwood, Stockport, Cheshire, Mast Height (m): 40.	347m	NE
165	Telecommunication Base Station, Location: Portwood, Stockwood, Cheshire, Mast Height (m): 67.	359m	SW
166	Telecommunication Base Station, Location: Brit Gas Nw, New Bridge Lane, Stockport, Cheshire, Mast Height (m): 63.	447m	E

<b>Map ID</b>	<b>Details</b>	<b>Distance</b>	<b>Direction</b>
167	Telecommunication Base Station, Location: Alan Howard Ltd, Woodbank Ind Est, Turncroft Lane, Stockport, Cheshire, Mast Height (m): 25.	472m	S
168	Telecommunication Base Station, Location: Alan Howard Ltd, Woodbank Ind Est, Turncroft Lane, Stockport, Cheshire, Mast Height (m): 24.	493m	S

# Historical Land Use

Details	Distance	Direction
<b>Historical Potentially Contaminative Uses</b>		
Historical Tanks and Energy Facilities		
Electrical Sub Station Facilities, Scale of Mapping: 1:1,250, Date of Mapping: 1989.	90m	S
Potential Tanks, Scale of Mapping: 1:1,250, Date of Mapping: 1959.	110m	SE
Potential Tanks, Scale of Mapping: 1:2,500, Date of Mapping: 1960.	110m	SE
Potential Tanks, Scale of Mapping: 1:1,250, Date of Mapping: 1959 - 1975.	118m	W
Potential Tanks, Scale of Mapping: 1:2,500, Date of Mapping: 1960.	119m	W
Electrical Sub Station Facilities, Scale of Mapping: 1:1,250, Date of Mapping: 1975 - 1989.	150m	W
Electrical Sub Station Facilities, Scale of Mapping: 1:1,250, Date of Mapping: 1989.	153m	S
Electrical Sub Station Facilities, Scale of Mapping: 1:1,250, Date of Mapping: 1975.	153m	S
Tanks, Scale of Mapping: 1:1,250, Date of Mapping: 1975.	262m	SW
Potential Tanks, Scale of Mapping: 1:2,500, Date of Mapping: 1960.	276m	SW
Potential Tanks, Scale of Mapping: 1:1,250, Date of Mapping: 1959.	276m	SW
Tanks, Scale of Mapping: 1:1,250, Date of Mapping: 1975 - 1989.	281m	SW
Electrical Sub Station Facilities, Scale of Mapping: 1:1,250, Date of Mapping: 1975 - 1989.	290m	SW
Potential Tanks, Scale of Mapping: 1:1,250, Date of Mapping: 1975.	291m	SW
Tanks, Scale of Mapping: 1:1,250, Date of Mapping: 1976.	328m	N
Gas Industry Facilities, Scale of Mapping: 1:1,250, Date of Mapping: 1975 - 1989.	329m	SW
Electrical Sub Station Facilities, Scale of Mapping: 1:1,250, Date of Mapping: 1975 - 1989.	354m	SW
Gas Industry Facilities, Scale of Mapping: 1:1,250, Date of Mapping: 1975.	363m	SW
Electrical Sub Station Facilities, Scale of Mapping: 1:1,250, Date of Mapping: 1975.	365m	E
Electrical Sub Station Facilities, Scale of Mapping: 1:1,250, Date of Mapping: 1989.	369m	W
Tanks, Scale of Mapping: 1:1,250, Date of Mapping: 1975 - 1989.	403m	SW
Potential Tanks, Scale of Mapping: 1:1,250, Date of Mapping: 1989.	433m	W
Tanks, Scale of Mapping: 1:1,250, Date of Mapping: 1975 - 1988.	434m	S
Potential Tanks, Scale of Mapping: 1:1,250, Date of Mapping: 1975.	438m	S
Gas Industry Facilities, Scale of Mapping: 1:1,250, Date of Mapping: 1972.	448m	SW
Gas Industry Facilities, Scale of Mapping: 1:1,250, Date of Mapping: 1972.	458m	SW
Tanks, Scale of Mapping: 1:1,250, Date of Mapping: 1972.	472m	SW
Potential Tanks, Scale of Mapping: 1:1,250, Date of Mapping: 1988.	483m	SW
Potential Tanks, Scale of Mapping: 1:1,250, Date of Mapping: 1975.	487m	SW
Electrical Sub Station Facilities, Scale of Mapping: 1:1,250, Date of Mapping: 1972.	495m	W
Potential Tanks, Scale of Mapping: 1:1,250, Date of Mapping: 1972.	500m	W

## Potentially Infilled Land

### Potentially Infilled Land (Non-Water)

Description: Unknown Filled Ground (Pit, quarry etc), Date of Mapping: 1993.	90m	N
Description: Unknown Filled Ground (Pit, quarry etc), Date of Mapping: 1993.	211m	NW
Description: Unknown Filled Ground (Pit, quarry etc), Date of Mapping: 1993.	243m	N
Description: Unknown Filled Ground (Pit, quarry etc), Date of Mapping: 1993.	460m	E

### Potentially Infilled Land (Water)

Description: Unknown Filled Ground (Pond, marsh, river, stream, dock etc), Date of Mapping: 1848.	291m	SW
Description: Unknown Filled Ground (Pond, marsh, river, stream, dock etc), Date of Mapping: 1882.	316m	SW

<b>Details</b>	<b>Distance</b>	<b>Direction</b>
Description: Unknown Filled Ground (Pond, marsh, river, stream, dock etc), Date of Mapping: 1954.	371m	SE
Description: Unknown Filled Ground (Pond, marsh, river, stream, dock etc), Date of Mapping: 1899.	382m	SW
Description: Unknown Filled Ground (Pond, marsh, river, stream, dock etc), Date of Mapping: 1954.	404m	NW
Description: Unknown Filled Ground (Pond, marsh, river, stream, dock etc), Date of Mapping: 1954.	450m	SE

The following maps have been manually reviewed by a consultant and presented in the Risk Analysis section at the front of this report.

<b>Scale</b>	<b>Map Sheet</b>	<b>Published Date</b>
1:2,500	Cheshire 010_11	1872
1:2,500	Cheshire 010_15	1874
1:2,500	Cheshire 010_12	1875
1:2,500	Cheshire 010_16	1875
1:2,500	Lancashire And Furness 112_09	1895
1:2,500	Cheshire 010_11	1898
1:2,500	Cheshire 010_12	1898
1:2,500	Cheshire 010_15	1898
1:2,500	Cheshire 010_16	1898
1:2,500	Lancashire And Furness 112_09	1907
1:2,500	Cheshire 010_11	1910
1:2,500	Cheshire 010_12	1910
1:2,500	Cheshire 010_15	1910
1:2,500	Cheshire 010_16	1910
1:2,500	Lancashire And Furness 112_09	1922
1:2,500	Lancashire And Furness 112_09	1934
1:2,500	National Grid SJ9090	1960
1:2,500	National Grid SJ9091	1960
1:10,560	Lancashire And Furness 112_00	1848
1:10,560	Cheshire 010_00	1882
1:10,560	Lancashire And Furness 112_NW	1894
1:10,560	Lancashire And Furness 112_SW	1895
1:10,560	Cheshire 010_SE	1899
1:10,560	Lancashire And Furness 112_SW	1910
1:10,560	Cheshire 010_SE	1911
1:10,560	Lancashire And Furness 112_NW	1911
1:10,560	Lancashire And Furness 112_NW	1923
1:10,560	Lancashire And Furness 112_SW	1923
1:10,560	Cheshire 010_SE	1938
1:10,560	National Grid SJ88NE	1954
1:10,560	National Grid SJ98NW	1954
1:10,560	National Grid SJ99SW	1954
1:10,560	National Grid SJ89SE	1955
1:10,560	National Grid SJ89SE	1965
1:10,560	National Grid SJ88NE	1966
1:10,560	National Grid SJ98NW	1969

<b>Scale</b>	<b>Map Sheet</b>	<b>Published Date</b>
1:10,560	National Grid SJ99SW	1971
1:10,000	National Grid SJ89SE	1976
1:10,000	National Grid SJ98NW	1977
1:10,000	National Grid SJ88NE	1978
1:10,000	National Grid SJ99SW	1980
1:10,000	National Grid SJ98NW	1983
1:10,000	National Grid SJ89SE	1985
1:10,000	National Grid SJ88NE	1984
1:10,000	National Grid SJ89SE	1990
1:10,000	National Grid SJ99SW	1993
1:10,000	National Grid SJ98NW	1995
1:10,000	National Grid SJ88NE	2010
1:10,000	National Grid SJ89SE	2010
1:10,000	National Grid SJ98NW	2010
1:10,000	National Grid SJ99SW	2010
1:1,250	National Grid SJ9090NE	1959
1:1,250	National Grid SJ9090NW	1959
1:1,250	National Grid SJ9091SE	1959
1:1,250	National Grid SJ9091SW	1959
1:1,250	National Grid SJ9090NE	1975
1:1,250	National Grid SJ9090NW	1975
1:1,250	National Grid SJ9091SW	1976
1:1,250	National Grid SJ9090NW	1989
1:1,250	National Grid SJ9090NW	1973
1:1,250	National Grid SJ9091SW	1975
1:1,250	National Grid SJ9090NE	1992
1:1,250	National Grid SJ9090NW	1992
1:1,250	National Grid SJ9091SE	1992
1:1,250	National Grid SJ9091SW	1992
1:1,250	National Grid SJ9090NE	1993
1:1,250	National Grid SJ9090NE	1996
1:1,250	National Grid SJ9091SW	1972
1:1,250	National Grid SJ9090NW	1982
1:1,250	National Grid SJ9090NE	1988
1:1,250	National Grid SJ9091SE	1988
1:1,250	National Grid SJ9091SW	1982
1:1,250	National Grid SJ9090NW	1987
1:1,250	National Grid SJ9091SE	1991
1:1,250	National Grid SJ9090NW	1988
1:1,250	National Grid SJ9091SW	1991

# Aquifer Designation (Superficial)

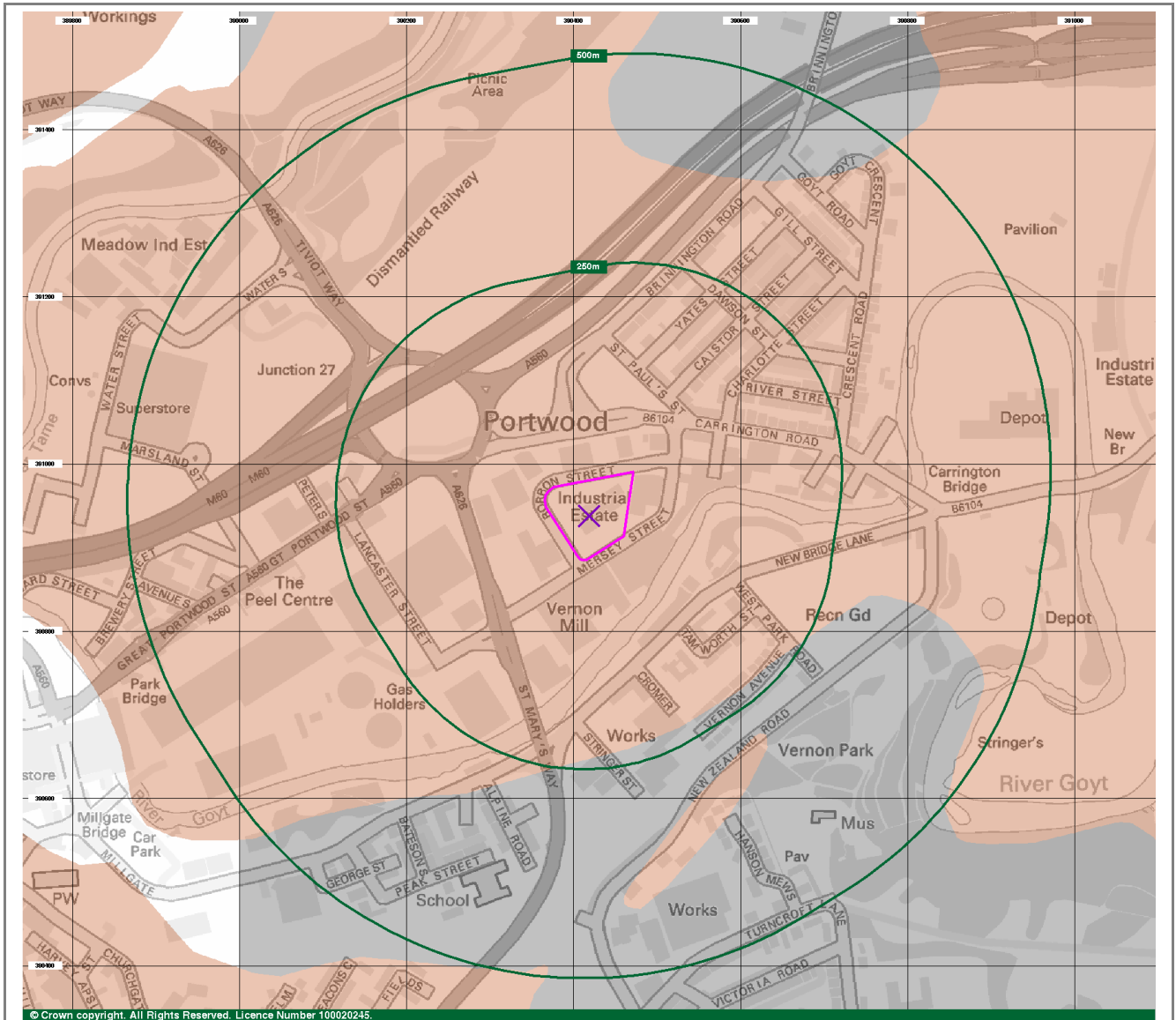

© Crown copyright. All Rights Reserved. Licence Number 100020245.

## Aquifer Designations

-  Site Boundary
-  Search Buffer
-  Bearing Reference Point
-  N
-  Principal Aquifer
-  Secondary A Aquifer
-  Secondary B Aquifer
-  Secondary Undifferentiated
-  Unproductive Strata
-  Unknown

# Aquifer Designation (Bedrock)

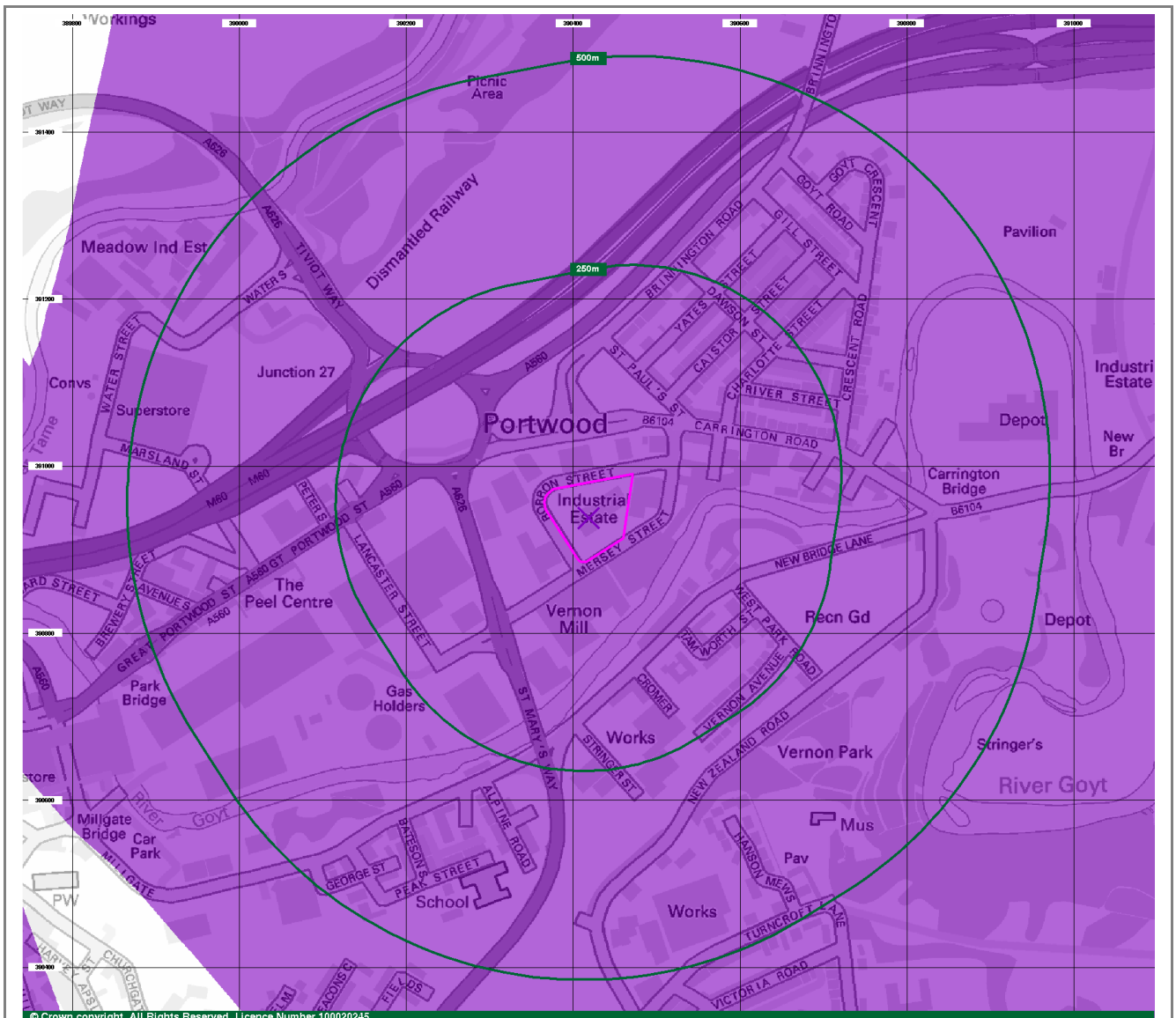

© Crown copyright. All Rights Reserved. Licence Number 100020245

## Aquifer Designations

-  Site Boundary
-  Search Buffer
-  Bearing Reference Point
-  N
-  Principal Aquifer
-  Secondary A Aquifer
-  Secondary B Aquifer
-  Secondary Undifferentiated
-  Unproductive Strata
-  Unknown

# Groundwater Vulnerability

Map ID	Details	Distance	Direction
	<b>Hydrogeology</b>		
	Superficial Aquifer Designations		
	Secondary Aquifer - A	0m	-
	Unproductive Strata	228m	SE
	Secondary Aquifer - A	286m	SE
	Unproductive Strata	366m	N
	Secondary Aquifer - A	366m	W
	Secondary Aquifer - A	487m	S
	Bedrock Aquifer Designations		
	Principal Aquifer	0m	-
	Principal Aquifer	366m	W
	Groundwater Vulnerability		
	Soil Classification: Soils of High Leaching Potential (U) - Soil information for restored mineral workings and urban areas is based on fewer observations than elsewhere. A worst case vulnerability classification (H) assumed, until proved otherwise, Map Scale: 1:100,000, Map Name: Sheet 17 Derbyshire & North Staffordshire.	0m	-
	Soil Classification: Soils of Intermediate Leaching Potential (I1) - Soils which can possibly transmit a wide range of pollutants, Map Scale: 1:100,000, Map Name: Sheet 17 Derbyshire & North Staffordshire.	496m	SE
	<b>Geology</b>		
	Low Permeability Drift Deposits		
	Drift Deposit: Low permeability drift deposits occurring at the surface and overlying Major and Minor Aquifers are head, clay-with-flints, brickearth, peat, river terrace deposits and marine and estuarine alluvium, Map Sheet: Sheet 17 Derbyshire & North Staffordshire, Scale: 1:100,000.	150m	SE
	Drift Deposit: Low permeability drift deposits occurring at the surface and overlying Major and Minor Aquifers are head, clay-with-flints, brickearth, peat, river terrace deposits and marine and estuarine alluvium, Map Sheet: Sheet 17 Derbyshire & North Staffordshire, Scale: 1:100,000.	362m	N
	BGS 1:50,000 Bedrock Geology		
	LEX Code: CS, Rock Name: Collyhurst Sandstone Formation, Rock Type: Sandstone, Min Age: Early Permian, Max Age: Early Permian.	0m	-
	LEX Code: CS, Rock Name: Collyhurst Sandstone Formation, Rock Type: Sandstone, Min Age: Early Permian, Max Age: Early Permian.	27m	W
	LEX Code: CS, Rock Name: Collyhurst Sandstone Formation, Rock Type: Sandstone, Min Age: Early Permian, Max Age: Early Permian.	376m	SW
	BGS 1:50,000 Superficial Deposits		
	LEX Code: RTDU, Rock Name: River Terrace Deposits (Undifferentiated), Rock Type: Sand and Gravel, Min Age: Quaternary, Max Age: Quaternary.	0m	-
	LEX Code: GFDUD, Rock Name: Glaciofluvial Deposits, Devensian, Rock Type: Sand and Gravel, Min Age: Devensian, Max Age: Devensian.	165m	NW
	LEX Code: RTDU, Rock Name: River Terrace Deposits (Undifferentiated), Rock Type: Sand and Gravel, Min Age: Quaternary, Max Age: Quaternary.	193m	N



Map ID	Details	Distance	Direction
	LEX Code: TILLD, Rock Name: Till, Devensian, Rock Type: Diamicton, Min Age: Devensian, Max Age: Devensian.	229m	SE
	LEX Code: GFDUD, Rock Name: Glaciofluvial Deposits, Devensian, Rock Type: Sand and Gravel, Min Age: Devensian, Max Age: Devensian.	287m	SE
	LEX Code: RTDU, Rock Name: River Terrace Deposits (Undifferentiated), Rock Type: Sand and Gravel, Min Age: Quaternary, Max Age: Quaternary.	343m	E
	LEX Code: ALV, Rock Name: Alluvium, Rock Type: Clay, Silt, Sand and Gravel, Min Age: Flandrian, Max Age: Flandrian.	385m	NW
	LEX Code: GFDUD, Rock Name: Glaciofluvial Deposits, Devensian, Rock Type: Sand and Gravel, Min Age: Devensian, Max Age: Devensian.	488m	S
	<b>BGS 1:50,000 Geological Mapping Coverage</b>		
	Map Sheet No: 098, MapName: Stockport, Map Date: 1977, Bedrock Geology: Available, Superficial Geology: Available, Artificial Geology: Not Available, Faults: Available, Landslip: Available, Rock Segments: Available.	0m	-
	<b>Detailed River Network Lines</b>		
	Primary River, River Name: River Goyt	67m	SE
	Hydrographic Area: D011, River Flow Type: Primary Flow Path, River Surface Level: Surface, Drain Feature: Not a Drain, Flood Risk Management Status: Flood Risk Management Indicative/Statutory Main River, Water Course Name: GOYT, Water Course Reference: GOYT.		
	Primary River, River Name: Not Supplied	346m	NE
	Hydrographic Area: D011, River Flow Type: Primary Flow Path, River Surface Level: Surface, Drain Feature: Not a Drain, Flood Risk Management Status: Flood Risk Management Indicative/Statutory Main River, Water Course Name: GOYT, Water Course Reference: GOYT.		
	Primary River, River Name: Not Supplied	348m	NE
	Hydrographic Area: D011, River Flow Type: Secondary Flow Path, River Surface Level: Surface, Drain Feature: Not a Drain, Flood Risk Management Status: Other Rivers, Water Course Name: Not Supplied, Water Course Reference: Not Supplied.		
	Primary River, River Name: Goyt	372m	NE
	Hydrographic Area: D011, River Flow Type: Primary Flow Path, River Surface Level: Surface, Drain Feature: Not a Drain, Flood Risk Management Status: Flood Risk Management Indicative/Statutory Main River, Water Course Name: GOYT, Water Course Reference: GOYT.		
	Primary River, River Name: Not Supplied	440m	SE
	Hydrographic Area: D011, River Flow Type: Secondary Flow Path, River Surface Level: Surface, Drain Feature: Not a Drain, Flood Risk Management Status: Other Rivers, Water Course Name: Not Supplied, Water Course Reference: Not Supplied.		
	Primary River, River Name: Not Supplied	450m	SE
	Hydrographic Area: D011, River Flow Type: Primary Flow Path, River Surface Level: Surface, Drain Feature: Not a Drain, Flood Risk Management Status: Flood Risk Management Indicative/Statutory Main River, Water Course Name: GOYT, Water Course Reference: GOYT.		
	Primary River, River Name: Gauge	450m	SE
	Hydrographic Area: D011, River Flow Type: Primary Flow Path, River Surface Level: Surface, Drain Feature: Not a Drain, Flood Risk Management Status: Flood Risk Management Indicative/Statutory Main River, Water Course Name: GOYT, Water Course Reference: GOYT.		
	Primary River, River Name: River Goyt	478m	SE
	Hydrographic Area: D011, River Flow Type: Primary Flow Path, River Surface Level: Surface, Drain Feature: Not a Drain, Flood Risk Management Status: Flood Risk Management Indicative/Statutory Main River, Water Course Name: GOYT, Water Course Reference: GOYT.		

Map ID	Details	Distance	Direction
	Primary River, River Name: Gauge Hydrographic Area: D011, River Flow Type: Secondary Flow Path, River Surface Level: Surface, Drain Feature: Not a Drain, Flood Risk Management Status: Other Rivers, Water Course Name: Not Supplied, Water Course Reference: Not Supplied.	478m	SE
	Primary River, River Name: Tame Hydrographic Area: D011, River Flow Type: Primary Flow Path, River Surface Level: Surface, Drain Feature: Not a Drain, Flood Risk Management Status: Flood Risk Management Indicative/Statutory Main River, Water Course Name: RIVER TAME, Water Course Reference: TAME.	486m	NW
	Primary River, River Name: River Goyt Hydrographic Area: D011, River Flow Type: Primary Flow Path, River Surface Level: Surface, Drain Feature: Not a Drain, Flood Risk Management Status: Flood Risk Management Indicative/Statutory Main River, Water Course Name: GOYT, Water Course Reference: GOYT.	499m	NE
	Extended Culvert (greater than 50m), River Name: Not Supplied Hydrographic Area: D011, River Flow Type: Primary Flow Path, River Surface Level: Below Surface, Drain Feature: Not a Drain, Flood Risk Management Status: Other Rivers, Water Course Name: Not Supplied, Water Course Reference: Not Supplied.	499m	NE
	Detailed River Network Offline Drainage None		
	BGS 1:625,000 Solid Geology Description: Permian basal breccias, sandstones and mudstones.	0m	-
	BGS Boreholes		
46	BGS Reference: Sj99sw261, Drilled Length (m): 6.5, Borehole Name: Stockport Ew Bypass Bh17.	24m	NW

# Environmentally Sensitive Features

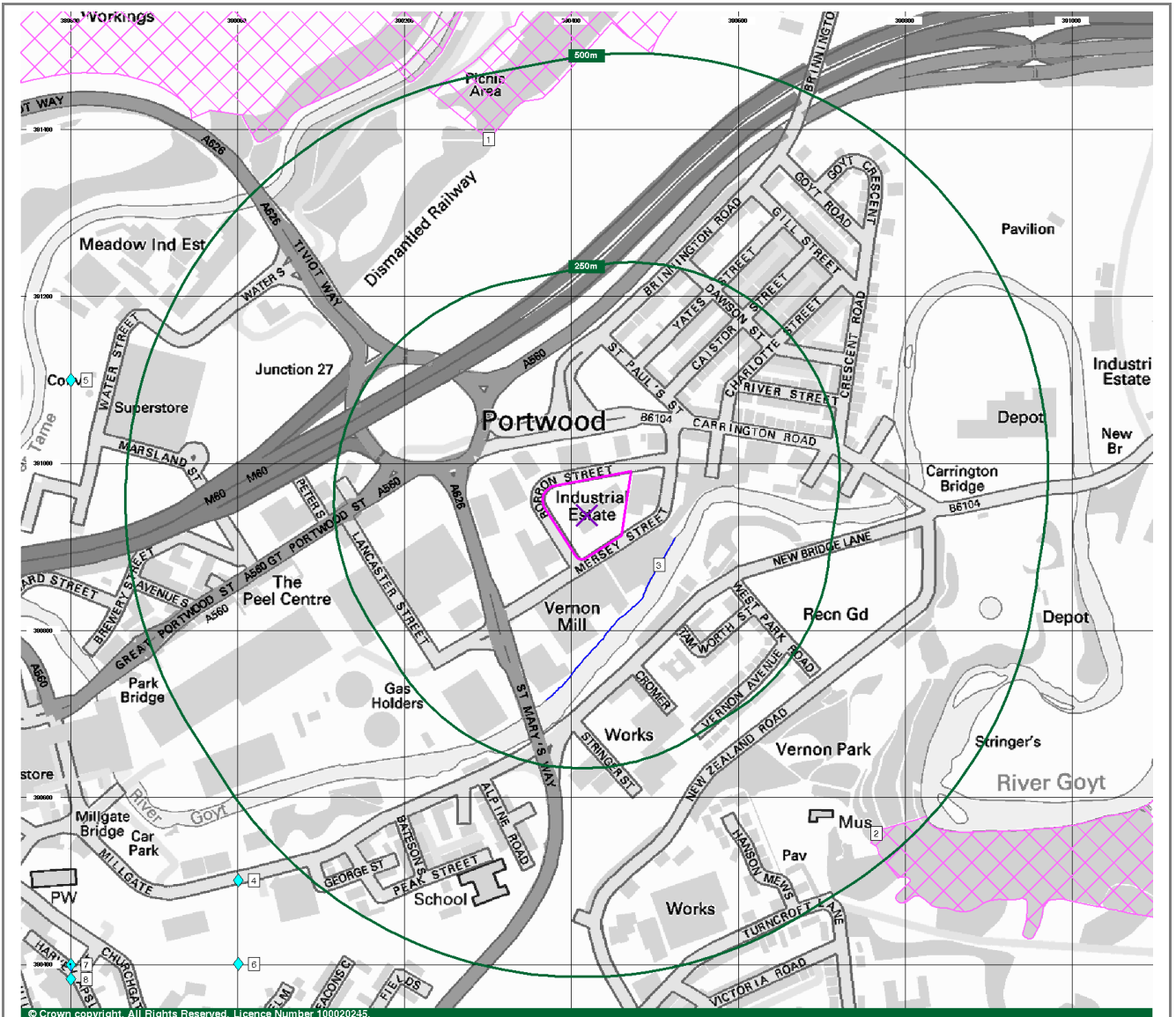

## Sensitive Land Uses

- |                                    |                         |                                     |
|------------------------------------|-------------------------|-------------------------------------|
| Site Boundary                      | Local Nature Reserve    | Ramsar Site                         |
| Search Buffer                      | Marine Nature Reserve   | Nearest Surface Water Feature       |
| Bearing Reference Point            | National Nature Reserve | Site of Special Scientific Interest |
| N                                  | National Park           | Special Area of Conservation        |
| Area of Outstanding Natural Beauty | National Scenic Area    | Special Protection Area             |
| Environmentally Sensitive Area     | Nitrate Sensitive Area  | Water Abstraction                   |
| Forest Park                        | Nitrate Vulnerable Zone | Historical Flood Liability          |

# Source Protection Zones

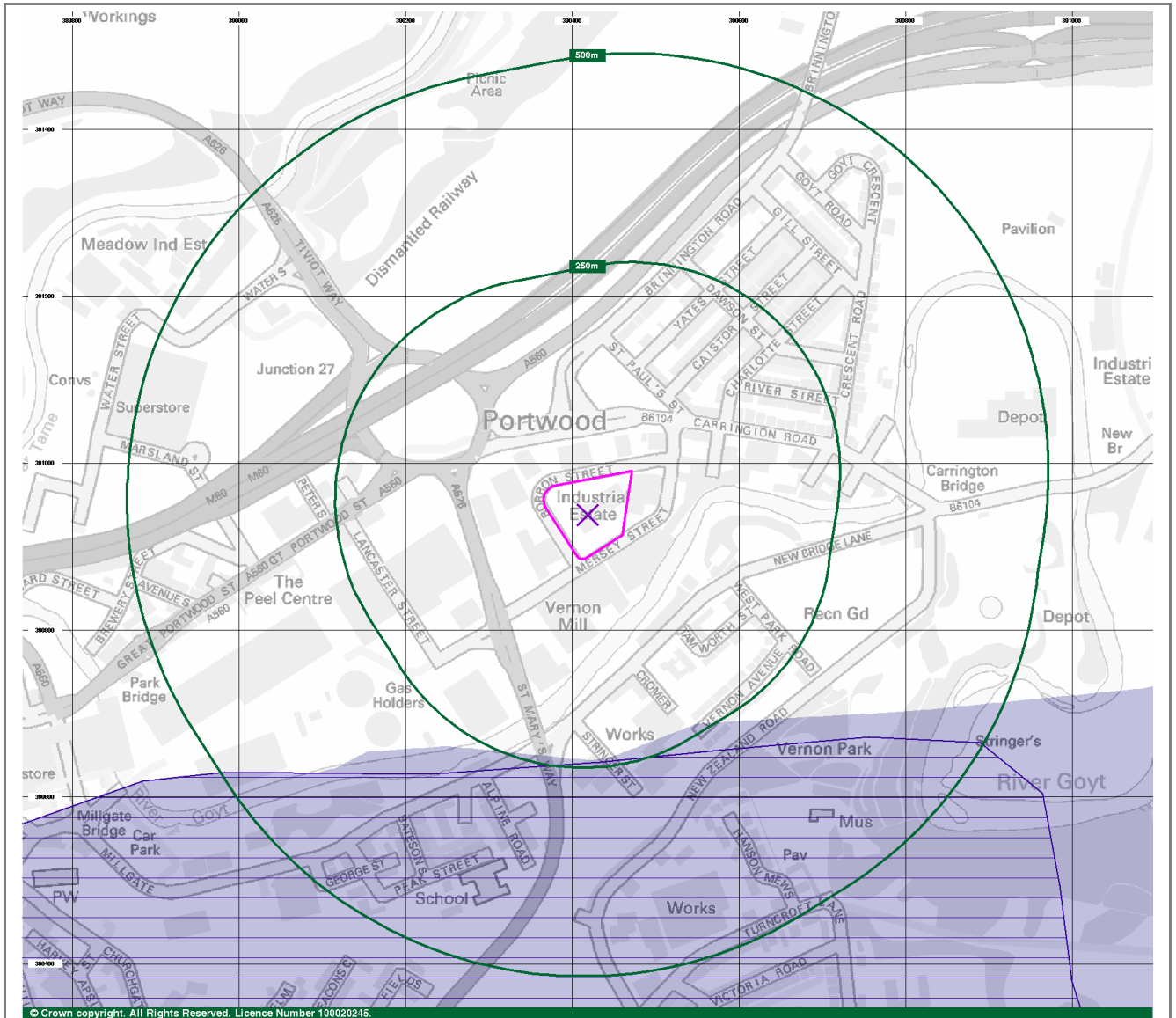

## Source Protection Zones

-  Site Boundary
-  Search Buffer
-  Bearing Reference Point
-  N
-  Source Protection Zone I
-  Source Protection Zone II
-  Source Protection Zone III
-  Zone of Special Interest
-  Source Protection Zone Borehole

# Environmentally Sensitive Features

Map ID	Details	Distance	Direction
<b>Environmentally Sensitive Features</b>			
Local Nature Reserves			
1	Name: Reddish Vale, Multiple Area: Y, Area (m <sup>2</sup> ): 808669.57, Source: Natural England, Designation Date: 1st February 2000.	423m	N
2	Name: Woodbank Park, Multiple Area: N, Area (m <sup>2</sup> ): 190775.03, Source: Natural England, Designation Date: 18th July 2008.	470m	SE
River Quality			
	Name: Goyt, Reach: Etherow Conf. To Tame Conf., Estimated Distance: 12.6, GQA Grade: River Quality C, Year: 2000, Flow Rate: Flow less than 10 cumecs.	175m	SE
	Name: Tame, Reach: Hyde Stw To Mersey, Estimated Distance: 14, GQA Grade: River Quality D, Year: 2000, Flow Rate: Flow less than 5 cumecs.	458m	NW
Nearest Surface Water Feature			
3	Surface water feature identified in proximity.	57m	SE
Water Abstractions			
4	Operator: Blythe Burrell Colours Ltd, Licence Number: 2569011025, Permit Version: Not Supplied, Location: Two Boreholes, STOCKPORT, Authority: Environment Agency, North West Region, Abstraction: Cooling & Manufacturing, Abstraction Type: Not Supplied, Source: Groundwater, Daily Rate(m <sup>3</sup> ): 2728, Yearly Rate (m <sup>3</sup> ): 454600, Additional Purpose: Cooling; Licence Status: Revoked, Authorised Start: Not Supplied, Authorised End: Not Supplied, Permit Start Date: Not Supplied, Permit End Date: Not Supplied, Positional Accuracy: Located by supplier to within 100m.	561m	SW
5	Operator: Salpa Kay Ltd., Licence Number: 2569012033, Permit Version: Not Supplied, Location: Presmises, Hope Mill, Portwood, STOCKPORT, Cheshire, Authority: Environment Agency, North West Region, Abstraction: Cooling, Abstraction Type: Not Supplied, Source: Surface, Daily Rate(m <sup>3</sup> ): 273, Yearly Rate (m <sup>3</sup> ): 68190, River Tame, Authorised Start: Not Supplied, Authorised End: Not Supplied, Permit Start Date: Not Supplied, Permit End Date: Not Supplied, Positional Accuracy: Located by supplier to within 100m.	583m	W
6	Operator: Blythe Burrell Colours Ltd, Licence Number: 2569011025, Permit Version: Not Supplied, Location: Two Boreholes, STOCKPORT, Authority: Environment Agency, North West Region, Abstraction: Cooling & Manufacturing, Abstraction Type: Not Supplied, Source: Groundwater, Daily Rate(m <sup>3</sup> ): 0, Yearly Rate (m <sup>3</sup> ): 0, Additional Purpose: Cooling; Licence Status: Revoked, Authorised Start: Not Supplied, Authorised End: Not Supplied, Permit Start Date: Not Supplied, Permit End Date: Not Supplied, Positional Accuracy: Located by supplier to within 100m.	634m	SW
7	Operator: Frederic Robinson Ltd, Licence Number: 2569011023, Permit Version: 101, Location: Boreholes (2) At Stockport, Authority: Environment Agency, North West Region, Abstraction: Breweries/Wine: Process Water, Abstraction Type: Water may be abstracted from a single point, Source: Groundwater, Daily Rate(m <sup>3</sup> ): Not Supplied, Yearly Rate (m <sup>3</sup> ): Not Supplied, Unicorn Brewery, Stockport, Authorised Start: 01 January, Authorised End: 31 December, Permit Start Date: 30th November 2004, Permit End Date: Not Supplied, Positional Accuracy: Located by supplier to within 100m.	779m	SW
8	Operator: Frederick Robinson Ltd, Licence Number: 2569011023, Permit Version: 100, Location: Boreholes (2) At Stockport, Authority: Environment Agency, North West Region, Abstraction: Breweries/Wine: Process Water, Abstraction Type: Water may be abstracted from a single point, Source: Groundwater, Daily Rate(m <sup>3</sup> ): 3637, Yearly Rate (m <sup>3</sup> ): 272760, Unicorn Brewery, Stockport, Authorised Start: 01 January, Authorised End: 31 December, Permit Start Date: 17th February 1966, Permit End Date: Not Supplied, Positional Accuracy: Located by supplier to within 100m.	779m	SW
Source Protection Zones			

Map ID	Details	Distance	Direction
	Name: Lower Hillgate, Source: Environment Agency, Head Office, Reference: Nw086, Type: Zone III (Total Catchment): The total area needed to support the discharge from the protected groundwater source.	234m	S
	Name: Lower Hillgate, Source: Environment Agency, Head Office, Reference: Nw086, Type: Zone II (Outer Protection Zone): Either 25% of the source area or a 400 day travel time whichever is greater.	244m	S

## Natural and Mining Related Hazards

Map ID	Details	Distance	Direction
	<b>Subsidence</b>		
	Collapsible Ground Stability Hazards		
	No Hazard.		
	Compressible Ground Stability Hazards		
	Risk: No Hazard, Source: British Geological Survey, National Geoscience Information Service.	0m	-
	Ground Dissolution Stability Hazards		
	No Hazard.		
	Landslide Ground Stability Hazards		
	Risk: Very Low, Source: British Geological Survey, National Geoscience Information Service.	0m	-
	Running Sand Ground Stability Hazards		
	Risk: Very Low, Source: British Geological Survey, National Geoscience Information Service.	0m	-
	Shrinking or Swelling Clay Subsidence Hazards		
	Risk: No Hazard, Source: British Geological Survey, National Geoscience Information Service.	0m	-
	Risk: Very Low, Source: British Geological Survey, National Geoscience Information Service.	216m	SE
	Non-Coal Mining Hazards		
	No Hazard.		
	<b>Radon</b>		
	Radon Potential		
	The property is in an intermediate probability radon area, as between 1 and 3% of homes are above the action level, Source: British Geological Survey, National Geoscience Information Service.	0m	-
	Radon Protective Measures		
	None, Source: British Geological Survey, National Geoscience Information Service.	0m	-
	<b>Mining</b>		
	Brine Compensation Areas		
	None.		
	Coal Mining Affected Areas		
	In an area which may be affected by coal mining activity. It is recommended that a coal mining report is obtained from the Coal Authority. Contact details are included in the Useful Contacts section of this report..	0m	-
	Mining Instability		
	Mining Evidence: Inconclusive Coal Mining, Source: Ove Arup & Partners, Boundary Quality: As Supplied.	0m	-
	BGS Recorded Mineral Sites		

<b>Map ID</b>	<b>Details</b>	<b>Distance</b>	<b>Direction</b>
47	Site Name: Portwood Sand Pit, Site Location: Portwood, Stockport, Source: British Geological Survey, National Geoscience Information Service, Reference: 91093, Type: Opencast, Status: Ceased, Operator: Unknown Operator, Operator Location: Not Supplied, Periodic Type: Quaternary, Geology: Glaciofluvial Deposits, Devensian, Commodity: Sand, Positional Accuracy: Located by supplier to within 10m.	264m	NW
48	Site Name: Portwood Gravel Pit, Site Location: Portwood, Stockport, Source: British Geological Survey, National Geoscience Information Service, Reference: 91085, Type: Opencast, Status: Ceased, Operator: Unknown Operator, Operator Location: Not Supplied, Periodic Type: Quaternary, Geology: Glaciofluvial Deposits, Devensian, Commodity: Sand and Gravel, Positional Accuracy: Located by supplier to within 10m.	297m	N
49	Site Name: New Bridge Sand Pit, Site Location: Portwood, Stockport, Source: British Geological Survey, National Geoscience Information Service, Reference: 91083, Type: Opencast, Status: Ceased, Operator: Unknown Operator, Operator Location: Not Supplied, Periodic Type: Quaternary, Geology: River Terrace Deposits, Commodity: Sand, Positional Accuracy: Located by supplier to within 10m.	492m	E



## Useful Contacts

Name and Address	Telephone/Fax/Email
Argyll Environmental Limited Tower Point 44 North Road Brighton BN1 1YR <a href="http://www.argyllenvironmental.com">www.argyllenvironmental.com</a>	Telephone 0845 458 5250 Fax 0845 458 5260 <a href="mailto:info@argyllenviro.com">info@argyllenviro.com</a>
Ensura Limited (for Environmental Insurance) Tower Point 44 North Road Brighton BN1 1YR <a href="http://www.ensura.co.uk">www.ensura.co.uk</a>	Telephone 0845 652 8585 Fax 0845 652 8686 <a href="mailto:info@ensura.co.uk">info@ensura.co.uk</a>
Stockport Metropolitan Borough Council Environmental Health Department, EEDD Stopford House Piccadilly Stockport SK1 3XE <a href="http://www.stockport.gov.uk">www.stockport.gov.uk</a>	Telephone 0161 474 4210 Fax: 0161 477 8589 <a href="mailto:environment.team@stockport.gov.uk">environment.team@stockport.gov.uk</a>
Environment Agency National Customer Contact Centre (NCCC) PO Box 544 Templeborough Rotherham S60 1BY	Telephone 08708 506 506
Health and Safety Executive HSE Infoline Caerphilly Business Park Caerphilly CF83 3GG <a href="http://www.hse.gov.uk">www.hse.gov.uk</a>	Telephone 08701 545500 Fax: 02920 859260 <a href="mailto:hseinformationservices@natbrit.com">hseinformationservices@natbrit.com</a>
Stockport Metropolitan Borough Council Environment and Economic Development Hygarth House 103 Wellington Road South Stockport Greater Manchester SK1 3TT <a href="http://www.stockport.gov.uk">www.stockport.gov.uk</a>	Telephone 0161 480 4949 Fax: 0161 477 9530
British Geological Survey Enquiry Service British Geological Survey Kingsley Dunham Centre Keyworth Nottingham Nottinghamshire NG12 5GG <a href="http://www.bgs.ac.uk">www.bgs.ac.uk</a>	Telephone 0115 936 3143 Fax: 0115 936 3276 <a href="mailto:enquiries@bgs.ac.uk">enquiries@bgs.ac.uk</a>
Natural England Northminster House Northminster Road Peterborough Cambridgeshire PE1 1UA <a href="http://www.naturalengland.org.uk">www.naturalengland.org.uk</a>	Telephone 0845 600 3078 Fax: 01733 455103 <a href="mailto:enquiries@naturalengland.org.uk">enquiries@naturalengland.org.uk</a>

<b>Name and Address</b>	<b>Telephone/Fax/Email</b>
The Coal Authority Mining Report Service 200 Lichfield Lane Mansfield Nottinghamshire NG18 4RG	Telephone 0845 7626848

Please note that the Environment Agency / SEPA have a charging policy in place for enquiries. When contacting these agencies please mention that this data has been received from the Landmark database, alternatively Argyll Environmental Limited would be pleased to assist with consultation to the above bodies. Please contact us for a quotation.